

**+NOTICE!!**

**These documents have been scanned!**

**Do not place un-scanned documents beneath this notice!**

**Do not remove this notice from this file!**

GPO Jacket No. 560-102  
Print Order 61540  
Rise Business Services, LLC  
Job=AZ15 7/15/2019



Box Number= AZ15163



Claim Begin-End: AMC338267-AMC338267

**1 Initial Receipt**



AZ15163-9

AMC337218-AMC338324

Date Prepared: July 3, 1996

Lead A MC Number: A MC 338267

Ending A MC Number: A MC

CASE CLAIM INDEX

SERIAL NUMBER

CLOSURE DECISION DATE

CLAIM NAME

A MC 338267

WYNYARRA

---

UNITED STATES  
DEPARTMENT OF THE INTERIOR  
BUREAU OF LAND MANAGEMENT

RECEIPT AND ACCOUNTING ADVICE

NO. **2190243**

04

TC/AZ

02/15/96

Subject: LOCATION & SERVICE FEE (1) 1 3 11 25.00  
CLAIM MAINTENANCE FEE 1996 (1) 1 3 12 10.00  
Applicant: 1 3 13 100.00

BILL/ARNETTA VITTITOW  
P.O. BOX 2644  
QUARTZSITE, AZ 85346

SAME AS CASH

Remitter:

APR 10 1996

ENTERED IN COMPUTER

3/28/96 Sprvas

Assignor:

LEASE MANAGEMENT DATA									
<input type="checkbox"/> NEW <input type="checkbox"/> UPDATE <input type="checkbox"/> PAYMENT									
ORIGINAL SERIAL NO.	ASG.	TYPE	ST.	CTY.	FUND SYMBOL			ACRES/UNITS	RATE
AMC 338267									
AMOUNT	ANV. DATE	EXP. DATE	BILL CYC.	S/C	DISTRICT	NEXT BILL	MISC. DATA	U of M	ACTUAL UNITS
ASSIGNMENT SERIAL NO.	ASG.	TYPE	ST.	CTY.	FUND SYMBOL			ACRES/UNITS	RATE
AMOUNT	ANV. DATE	EXP. DATE	BILL CYC.	S/C	DISTRICT	NEXT BILL	MISC. DATA	U of M	ACTUAL UNITS

APPLY REMITTANCE

ACTION	FUND SYMBOL	CTY.	AMOUNT
FILING FEE			
RENTAL			
UNEARNED			
REFUND			
TOTAL			
AMOUNT DUE			

Remarks:

BY: \_\_\_\_\_ DATE: \_\_\_\_\_

Lease in Escrow?  
 KGS?                      Of Interest?  
 Auto Escalates?            Operating Rights?  
 Auto Renew?                Operator  
 \_\_\_\_\_ Bond Filed?

**FOR MMS USE ONLY**

BILLEE	FOREST REFUGE
NUMBER	
OCS SECTION	
CODE	

**NOTICE!!**

**These documents have been scanned!**

**Do not place un-scanned documents beneath this notice!**

**Do not remove this notice from this file!**

GPO Jacket No. 560-102  
Print Order 61540  
Rise Business Services, LLC  
Job=AZ15 7/15/2019



Box Number= AZ15163



Claim Begin-End: AMC338267-AMC338267

**2 Correspondence**



AZ15163-9

AMC337218-AMC338324

**NO  
DOCUMENTS  
FOUND**

NO DOCUMENTS FOUND  
NO DOCUMENTS FOUND

**NOTICE!!**

**These documents have been scanned!**

**Do not place un-scanned documents beneath this notice!**

**Do not remove this notice from this file!**

GPO Jacket No. 560-102  
Print Order 61540  
Rise Business Services, LLC  
Job=AZ15 7/15/2019



Box Number= AZ15163



Claim Begin-End: AMC338267-AMC338267

**3 Transfers**



AZ15163-9

AMC337218-AMC338324

**NO  
DOCUMENTS  
FOUND**

NO DOCUMENTS FOUND  
NO DOCUMENTS FOUND

**NOTICE!!**

**These documents have been scanned!**

**Do not place un-scanned documents beneath this notice!**

**Do not remove this notice from this file!**

GPO Jacket No. 560-102  
Print Order 61540  
Rise Business Services, LLC  
Job=AZ15 7/15/2019



Box Number= AZ15163



Claim Begin-End: AMC338267-AMC338267

**4 Annual Filings**



AZ15163-9

AMC337218-AMC338324



DEPARTMENT OF THE INTERIOR  
BUREAU OF LAND MANAGEMENT  
MINING CLAIMS

Run Date/Time: 8/27/2019

MC Maintenance Fees Paid Through the BLM Pay Portal  
(by Date Paid)

Page 138 Of 216

---

**CBS Receipt: 4540410**

Printed For Lead File # AMC338267

Agency Tracking ID: 1566498684

Assessment Year: 2020

Number of BLM Serial Nr: 1

Paid On: 8/22/2019

Total Amount Paid: \$165.00

Claim Name	BLM Serial No	Lead File No	Amount Paid
WYNYARRA	AMC338267	AMC338267	\$165.00

**United States Department of the Interior**  
**Bureau of Land Management**  
 BUSINESS & SUPPORT SVCS DIV  
 ONE N CENTRAL AVE SUITE 800  
 PHOENIX, AZ 85004 -4427  
 Phone: 602-417-9200

Receipt	
No:	4540410

<b>Transaction #:</b> 4661361	
<b>Date of Transaction:</b> 08/22/2019	
CUSTOMER:	
MELVIN SHOCKEY 649 E 16TH ST SAN BENADINO,CA 92404 US	

LINE #	QTY	DESCRIPTION	REMARKS	UNIT PRICE	TOTAL
1	1.00	LOCATABLE MINERALS / MINING CLAIMS- NOT NEW-UNADJUD,ONE AUTH NO. ONLY / MINING CLAIM MONEY RECEIVED CASES: AMC338267/\$165.00		- n/a -	165.00
<b>TOTAL:</b>					<b>\$165.00</b>

PAYMENT INFORMATION			
NOTE: Items will appear on credit card statement as "BLM O Mining Claim".			
1	AMOUNT:	165.00	POSTMARKED: N/A
	TYPE:	CREDIT CARD	RECEIVED: 08/22/2019
	NAME:	MELVIN SHOCKEY 649 E 16TH ST SAN BENADINO CA 92404 US	
	CARD NO:	XXXXXXXXXXXX7889	AUTH CODE: 03329C
	NAME ON CARD:	MELVIN SHOCKEY	
	SIGNATURE:	INTERNET	

REMARKS

This receipt was generated by the automated BLM Collections and Billing System and is a paper representation of a portion of the official electronic record contained therein.

UNITED STATES  
DEPARTMENT OF THE INTERIOR  
BUREAU OF LAND MANAGEMENT

338267

**CREDIT CARD PAYMENT**  
For Mining Claim Maintenance Fee

TELEPHONE SUBMISSION - ACCURACY OF THE BELOW INFORMATION IS THE RESPONSIBILITY OF THE CLAIMANT/OWNER

NAME MELVIN SHOCKEY  
ADDRESS 649 E 16<sup>TH</sup> STREET  
CITY SAN BERNARDINO STATE CA ZIP 92404  
PHONE # 909 - 985-6095

SEND RECEIPT TO  Above address  
 Other (Include Name and Mailing Address):

AMC NUMBER  
338267

CLAIM/SITE NAME  
YNYARRA

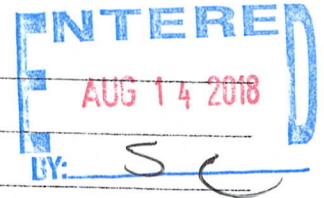

1 # of Claim/Site  
x 155.00 Each  
\$ 155.00 Total Charged PER (INITIALS)

RECEIPT # 4234589

DATE STAMP

RECEIVED  
BLM AZ STATE OFFICE  
2018 AUG 13 P 3:51  
PHOENIX, ARIZONA

\*\*\*\* FOR OFFICIAL USE ONLY \*\*\*\*

DATE \_\_\_\_\_ INITIALS \_\_\_\_\_ VERIFIED \_\_\_\_\_

**United States Department of the Interior**  
**Bureau of Land Management**  
 DIV OF LANDS, MINRLS & ENERGY  
 ONE N CENTRAL AVE  
 PHOENIX, AZ 85004 -4427  
 Phone: 602-417-9200

Receipt

No: 4234589

<b>Transaction #:</b> 4349943	
<b>Date of Transaction:</b> 08/14/2018	
<b>CUSTOMER:</b>	
MELVIN E SHOCKEY 649 E 16TH ST SAN BERNARDINO, CA 92404-5117 US	

LINE #	QTY	DESCRIPTION	REMARKS	UNIT PRICE	TOTAL
1	1.00	LOCATABLE MINERALS / MINING CLAIMS-NOT NEW-UNADJUD, ONE AUTH NO. ONLY / MINING CLAIM MONEY RECEIVED CASES: AMC338267/\$155.00	2019 MAINT/1	- n/a -	155.00
<b>TOTAL:</b>					<b>\$155.00</b>

PAYMENT INFORMATION				
NOTE: Items will appear on credit card statement as "Bureau of Land Mgmt CO".				
1	AMOUNT:	155.00	POSTMARKED:	N/A
	TYPE:	CREDIT CARD	RECEIVED:	08/14/2018
	NAME:	SHOCKEY, MELVIN E 649 E 16TH ST SAN BERNARDINO CA 92404-5117 US		
	CARD NO:	XXXXXXXXXXXX3419	AUTH CODE:	06077D
	NAME ON CARD:	MELVIN E SHOCKEY		
	SIGNATURE:			

REMARKS

This receipt was generated by the automated BLM Collections and Billing System and is a paper representation of a portion of the official electronic record contained therein.

Run Date: 02/05/17

Run Time: 02:33 PM

**DEPARTMENT OF THE INTERIOR  
BUREAU OF LAND MANAGEMENT  
MINING CLAIMS**

**MC Maintenance Fees Paid Through the BLM Pay Portal**

**CBS Receipt: 3963918**

Printed For Lead File # AMC338267

Agency Tracking ID: 1503954348

Assessment Year: 2018

Number of BLM Serial Nr: 1

Paid On: 08/28/2017

Total Amount Paid: \$155.00

Claim Name	BLM Serial No	Lead File No	Amount Paid
WYNYARRA	AMC338267	AMC338267	\$155.00

**United States Department of the Interior**  
**Bureau of Land Management**  
 BUSINESS & SUPPORT SVCS DIV  
 ONE N CENTRAL AVE SUITE 800  
 PHOENIX, AZ 85004 -4427  
 Phone: 602-417-9200

Receipt

No: 3963918

<b>Transaction #:</b> 4073791	
<b>Date of Transaction:</b> 08/28/2017	
<b>CUSTOMER:</b>	
MELVIN E SHOCKEY 649 E 16TH ST SAN BERNARDINO, CA 92404 US	

LINE #	QTY	DESCRIPTION	REMARKS	UNIT PRICE	TOTAL
1	1.00	LOCATABLE MINERALS / MINING CLAIMS- NOT NEW-UNADJUD, ONE AUTH NO. ONLY / MINING CLAIM MONEY RECEIVED CASES: AMC338267/\$155.00		- n/a -	155.00
<b>TOTAL:</b>					<b>\$155.00</b>

PAYMENT INFORMATION			
NOTE: Items will appear on credit card statement as "BLM O Mining Claim".			
1	AMOUNT:	155.00	POSTMARKED: N/A
	TYPE:	CREDIT CARD	RECEIVED: 08/28/2017
	NAME:	MELVIN E SHOCKEY 649 E 16TH ST SAN BERNARDINO CA 92404 US	
	CARD NO:	XXXXXXXXXXXX3419	AUTH CODE: 04739D
	NAME ON CARD:	MELVIN E SHOCKEY	
	EXPIRES:	06/2021	
	SIGNATURE:		

REMARKS

This receipt was generated by the automated BLM Collections and Billing System and is a paper representation of a portion of the official electronic record contained therein.

UNITED STATES  
DEPARTMENT OF THE INTERIOR  
BUREAU OF LAND MANAGEMENT

338267

**CREDIT CARD PAYMENT**  
**For Mining Claim Maintenance Fee**

THIS IS A CHANGE OF ADDRESS

TELEPHONE SUBMISSION - ACCURACY OF THE BELOW INFORMATION IS THE RESPONSIBILITY OF THE CLAIMANT/OWNER

NAME MELVIN SHOCKEY  
ADDRESS 649 E 16<sup>TH</sup> STREET  
CITY SAN BERNARDINO STATE CA ZIP 92404  
PHONE # 909 - 885 6095

SEND RECEIPT TO  Above address  
 Other (Include Name and Mailing Address):  
\_\_\_\_\_  
\_\_\_\_\_  
\_\_\_\_\_

AMC NUMBER  
338267

CLAIM/SITE NAME  
WYNYARRA

1 # of Claim/Site  
x 155.00 Each  
\$ 155<sup>00</sup> Total Charged PER (INITIALS)

RECEIPT # 3630328

DATE STAMP

ENTERED  
AUG 16 2016  
BY: RAM

RECEIVED  
BLM/ALBANY OFFICE  
2016 AUG 15 A 10:51  
PHOENIX, ARIZONA

\*\*\*\* FOR OFFICIAL USE ONLY \*\*\*\*

DATE \_\_\_\_\_ INITIALS \_\_\_\_\_ VERIFIED \_\_\_\_\_

**DEPARTMENT OF THE INTERIOR  
BUREAU OF LAND MANAGEMENT  
MINING CLAIMS  
(MASS) Serial Register Page**

RunDate/Time: 08/15/16 12:18 PM

Page: 1 of 2

01 10-21-1976;090STAT0090;43USC1744

Case Type 384201: PLACER CLAIM

Commodity:

Claim Name: WYNYARRA

Case Disposition: ACTIVE

Required Maintenance Fee: \$155.00

Total Acres

20.000

Serial Number

AMC338267

Lead File Number

AMC338267

Name & Address			Int Rel
SHOCKEY MELVIN	649 E 16TH ST	SAN BERNARDINO, CA 92404-5117	CLAIMANT
SHOCKEY SUSAN	649 E 16TH ST	SAN BERNARDINO, CA 92404-5117	CLAIMANT
VITTITOW ARNETTA	2697 BEARCAT DR	LAS CRUCES, NM 88001-1598	CLAIMANT
County/State	District		
LA PAZ County, AZ	COLORADO RIVER DO		

Mer	Twp	Rng	Sec	Subdivision
14	0040N	0210W	026	NW
14	0040N	0210W	027	NE

Act Date	Code	Action Text	Action Remarks	Receipt Number
02/14/1996	403	LOCATION DATE		
02/15/1996	395	RECORDATION NOTICE RECD		
08/11/2014	782	MAINTENANCE FEE PAYMENT	2016;\$155	3098100
08/11/2014	782	MAINTENANCE FEE PAYMENT	2015;\$155	3098758
08/15/2013	682	MAINTENANCE FEE/\$140	2014;\$140	2856514
08/29/2012	682	MAINTENANCE FEE/\$140	2013;\$140	2644347
08/26/2011	682	MAINTENANCE FEE/\$140	2012	2416783
08/13/2010	682	MAINTENANCE FEE/\$140	2011	2190531
08/20/2009	682	MAINTENANCE FEE/\$140	2010	1982781
08/06/2008	582	MAINTENANCE FEE/\$125	2009	1755217
08/13/2007	582	MAINTENANCE FEE/\$125	2008	1542120
08/14/2006	582	MAINTENANCE FEE/\$125	2007	1334624
08/09/2005	582	MAINTENANCE FEE/\$125	2006	1124661
08/03/2004	582	MAINTENANCE FEE/\$125	2005	920621
08/11/2003	482	MAINTENANCE FEE/\$100	2004	727667
08/12/2002	482	MAINTENANCE FEE/\$100	2003	538435
08/25/2001	482	MAINTENANCE FEE/\$100	2002	365053
08/26/2000	482	MAINTENANCE FEE/\$100	2001	187141
08/23/1999	482	MAINTENANCE FEE/\$100	2000	
08/26/1998	482	MAINTENANCE FEE/\$100	1999	
08/14/1997	482	MAINTENANCE FEE/\$100	1998	
08/23/1996	482	MAINTENANCE FEE/\$100	1997	
02/15/1996	482	MAINTENANCE FEE/\$100	1996	
08/07/2001	396	TRF OF INTEREST FILED	VITTITOW BILL	365053
08/24/1999	113	ADDITIONAL INFO RECEIVED	RECEIPT 2296783	
08/27/1998	113	ADDITIONAL INFO RECEIVED	RECEIPT 2389712	
08/14/1997	113	ADDITIONAL INFO RECEIVED	RECEIPT 2315305	
08/23/1996	113	ADDITIONAL INFO RECEIVED	RECEIPT 2263362	
02/15/1996	501	ACCT ADV IN LEAD FILE	AMC338267	

NO WARRANTY IS MADE BY BLM  
FOR USE OF THE DATA FOR  
PURPOSES NOT INTENDED BY BLM



**DEPARTMENT OF THE INTERIOR  
BUREAU OF LAND MANAGEMENT  
MINING CLAIMS  
(MASS) Serial Register Page**

RunDate/Time: 08/15/16 12:18 PM

Page: 2 of 2

---

02/15/1996	669	LAND STATUS CHECKED	
02/14/1996	404	COUNTY RECORDATION	9600971

---

Line Nr      Remarks

**NO WARRANTY IS MADE BY BLM  
FOR USE OF THE DATA FOR  
PURPOSES NOT INTENDED BY BLM**

**United States Department of the Interior**  
**Bureau of Land Management**  
 DIV OF LANDS, MINRLS & ENERGY  
 ONE N CENTRAL AVE  
 PHOENIX, AZ 85004 -4427  
 Phone: 602-417-9200

Receipt

No: 3630328

<b>Transaction #:</b> 3734115	
<b>Date of Transaction:</b> 08/15/2016	
<b>CUSTOMER:</b>	
MELVIN E SHOCKEY 649 E 16TH ST SAN BERNARDINO, CA 92404-5117 US	

LINE #	QTY	DESCRIPTION	REMARKS	UNIT PRICE	TOTAL
1	1.00	LOCATABLE MINERALS / MINING CLAIMS- NOT NEW-UNADJUD, ONE AUTH NO. ONLY / MINING CLAIM MONEY RECEIVED CASES: AMC338267/\$155.00	2017 MAINT/1	- n/a -	155.00
<b>TOTAL:</b>					<b>\$155.00</b>

PAYMENT INFORMATION			
NOTE: Items will appear on credit card statement as "Bureau of Land Mgmt CO".			
1	AMOUNT:	155.00	POSTMARKED: N/A
	TYPE:	CREDIT CARD	RECEIVED: 08/15/2016
	NAME:	SHOCKEY, MELVIN E 649 E 16TH ST SAN BERNARDINO CA 92404-5117 US	
	CARD NO:	XXXXXXXXXXXX3419	AUTH CODE: 01762C
	NAME ON CARD:	MELVIN E SHOCKEY	
	EXPIRES:	06/2018	
	SIGNATURE:		

<b>REMARKS</b>

This receipt was generated by the automated BLM Collections and Billing System and is a paper representation of a portion of the official electronic record contained therein.

UNITED STATES  
DEPARTMENT OF THE INTERIOR  
BUREAU OF LAND MANAGEMENT  
**MAINTENANCE FEE PAYMENT FORM  
FOR PLACER MINING CLAIMS**

338267

Remitter Name: Melvin E. Shockey  
Mailing Address: 649 E. 16th Street  
City, State, Zip: San Bernardino Ca 92404

Check here if this is a change of address.

**FOR COUNTY RECORDER'S USE**

No. of claims 1  
Total due BLM \$ 155.00

- The maintenance fee may be paid by cash, check, money order, Bureau of Land Management (BLM) Declining Deposit Account, or credit card (VISA, American Express, Discover, or MasterCard). Payments must be remitted to the BLM State Office where your claim or site is recorded and received on or before September 1. If the payment is mailed, the envelope must be postmarked by a bona fide delivery service on or before September 1 and received at the proper BLM State Office within 15 calendar days after the due date. Payments may also be made by telephone using a credit card. A complete listing of BLM State Offices with their addresses and phone numbers can be found at <http://www.blm.gov>.
- The maintenance fee for the following claim(s) applies to the assessment year 2014.

CLAIM NAME	BLM SERIAL NO.	ACRES IN CLAIM	PAYMENT DUE TO THE BLM (See Instructions on Page 2)
Wynwarra	AMC338267	20	155.00

RECEIVED  
BLM AZ STATE OFFICE  
2014 AUG 11 A 11:44  
PHOENIX, ARIZONA

Use a separate sheet for additional claim names, serial numbers, and claimant names and addresses.

# 3098100

**United States Department of the Interior**  
**Bureau of Land Management**  
 LANDS/RECREATION & PLANNING  
 ONE N CENTRAL AVE  
 PHOENIX, AZ 85004 -2203  
 Phone: 602-417-9200

Receipt

No: 3098100

<b>Transaction #:</b> 3189622	
<b>Date of Transaction:</b> 08/11/2014	
<b>CUSTOMER:</b>	
MELVIN E SHOCKEY 649 E 16TH ST SAN BERNARDINO, CA 92404-5117 US	

LINE #	QTY	DESCRIPTION	REMARKS	UNIT PRICE	TOTAL
1	1.00	LOCATABLE MINERALS / MINING CLAIMS- NOT NEW-UNADJUD, ONE AUTH NO. ONLY / MINING CLAIM MONEY RECEIVED <b>CASES: AMC338267/\$155.00</b>	MAINT <del>2015/1</del> 2014	- n/a -	155.00
<b>TOTAL:</b>					<b>\$155.00</b>

PAYMENT INFORMATION			
NOTE: Items will appear on credit card statement as "Bureau of Land Mgmt CO".			
1	AMOUNT:	155.00	POSTMARKED: N/A
	TYPE:	CREDIT CARD	RECEIVED: 08/11/2014
	NAME:	SHOCKEY, MELVIN E 649 E 16TH ST SAN BERNARDINO CA 92404-5117 US	
	CARD NO:	XXXXXXXXXXXX0107	AUTH CODE: 005563
	NAME ON CARD:	MELVIN E SHOCKEY	
	EXPIRES:	06/2015	
	SIGNATURE:		

REMARKS

This receipt was generated by the automated BLM Collections and Billing System and is a paper representation of a portion of the official electronic record contained therein.

Amc 338267

**United States Department of the Interior**  
**Bureau of Land Management**  
 BUSINESS & SUPPORT SVCS DIV  
 ONE N CENTRAL AVE SUITE 800  
 PHOENIX, AZ 85004 -4427  
 Phone: (602) 417-9200

Receipt

No: 3098758

<b>Transaction #:</b> 3190286	
<b>Date of Transaction:</b> 08/11/2014	
CUSTOMER:	
MELVIN E. SHOCKEY 649 EAST 16TH ST SAN BRNARDINO, CA 92404	

LINE #	QTY	DESCRIPTION	REMARKS	UNIT PRICE	TOTAL
1	1.00	LOCATABLE MINERALS / MINING CLAIMS- NOT NEW-UNADJUD, ONE AUTH NO. ONLY / MINING CLAIM MONEY RECEIVED CASES: AMC338267/\$155.00	2015	- n/a -	155.00
<b>TOTAL:</b>					<b>\$155.00</b>

PAYMENT INFORMATION			
NOTE: Items will appear on credit card statement as "BLM Denver, Colorado".			
1	AMOUNT:	155.00	POSTMARKED: N/A
	TYPE:	CREDIT CARD	RECEIVED: 08/11/2014
	NAME:	MELVIN E. SHOCKEY 649 EAST 16TH ST SAN BRNARDINO CA 92404	
	CARD NO:	XXXXXXXXXXXX0107	AUTH CODE: 005685
	NAME ON CARD:	MELVIN E. SHOCKEY	
	EXPIRES:	06/2015	
	SIGNATURE:		

REMARKS

This receipt was generated by the automated BLM Collections and Billing System and is a paper representation of a portion of the official electronic record contained therein.

**ENTERED**  
 AUG 13 2014  
 BY: AT

**United States Department of the Interior**  
**Bureau of Land Management**  
 BUSINESS & SUPPORT SVCS DIV  
 ONE N CENTRAL AVE SUITE 800  
 PHOENIX, AZ 85004 -4427  
 Phone: (602) 417-9200

Receipt

No: 3098758

<b>Transaction #:</b> 3190286	
<b>Date of Transaction:</b> 08/11/2014	
<b>CUSTOMER:</b>	
MELVIN E. SHOCKEY 649 EAST 16TH ST SAN BRNARDINO, CA 92404	

LINE #	QTY	DESCRIPTION	REMARKS	UNIT PRICE	TOTAL
1	1.00	LOCATABLE MINERALS / MINING CLAIMS- NOT NEW-UNADJUD, ONE AUTH NO. ONLY / MINING CLAIM MONEY RECEIVED <b>CASES: AMC338267/\$155.00</b>		- n/a -	155.00
<b>TOTAL:</b>					<b>\$155.00</b>

PAYMENT INFORMATION			
NOTE: Items will appear on credit card statement as "BLM Denver, Colorado".			
1	AMOUNT:	155.00	POSTMARKED: N/A
	TYPE:	CREDIT CARD	RECEIVED: 08/11/2014
	NAME:	MELVIN E. SHOCKEY 649 EAST 16TH ST SAN BRNARDINO CA 92404	
	CARD NO:	XXXXXXXXXXXX0107	AUTH CODE: 005685
	NAME ON CARD:	MELVIN E. SHOCKEY	
	EXPIRES:	06/2015	
	SIGNATURE:		

REMARKS

This receipt was generated by the automated BLM Collections and Billing System and is a paper representation of a portion of the official electronic record contained therein.

AMC 338267

**United States Department of the Interior**  
**Bureau of Land Management**  
 LANDS/RECREATION & PLANNING  
 ONE N CENTRAL AVE  
 PHOENIX, AZ 85004 -2203  
 Phone: 602-417-9200

Receipt

No: 3098100

<b>Transaction #:</b> 3189622	
<b>Date of Transaction:</b> 08/11/2014	
<b>CUSTOMER:</b>	
MELVIN E SHOCKEY 649 E 16TH ST SAN BERNARDINO, CA 92404-5117 US	

LINE #	QTY	DESCRIPTION	REMARKS	UNIT PRICE	TOTAL
1	1.00	LOCATABLE MINERALS / MINING CLAIMS- NOT NEW-UNADJUD, ONE AUTH NO. ONLY / MINING CLAIM MONEY RECEIVED <b>CASES:</b> AMC338267/\$155.00	MAINT 2015/1 2016	- n/a -	155.00
<b>TOTAL:</b>					<b>\$155.00</b>

PAYMENT INFORMATION			
NOTE: Items will appear on credit card statement as "Bureau of Land Mgmt CO".			
1	AMOUNT:	155.00	POSTMARKED: N/A
	TYPE:	CREDIT CARD	RECEIVED: 08/11/2014
	NAME:	SHOCKEY, MELVIN E 649 E 16TH ST SAN BERNARDINO CA 92404-5117 US	
	CARD NO:	XXXXXXXXXXXX0107	AUTH CODE: 005563
	NAME ON CARD:	MELVIN E SHOCKEY	
	EXPIRES:	06/2015	
	SIGNATURE:		

REMARKS

This receipt was generated by the automated BLM Collections and Billing System and is a paper representation of a portion of the official electronic record contained therein.

PHONED IN A PAYMENT AND  
 MADE PAYMENT THROUGH PAYMENT  
 PORTAL. CUSTOMER SAID APPLY IT  
 TO 2016 FILING. PM

ENTERED  
 AUG 19 2014  
 BY: PM

**DEPARTMENT OF THE INTERIOR  
BUREAU OF LAND MANAGEMENT  
MINING CLAIMS**

Run Date/Time: 08/19/2014 11:03 AM

**(LIVE) Serial Register Page**

Page 1 of 2

**01 10-21-1976;090STAT0090;43USC1744**

**Case Type 384201: PLACER CLAIM**

**Claim Name: WYNYARRA**

**Commodity :**

**Case Disposition: ACTIVE**

**Required Maintenance Fee: \$155.00**

**Total Acres**

**20.000**

**Serial Number**

**AMC338267**

**Lead File Number**

**AMC338267**

Name & Address				Int	Rel
SHOCKEY SUSAN	649 E 16TH ST	SAN BERNARDINO, CA 92404-5117		CLAIMANT	
SHOCKEY MELVIN	649 E 16TH ST	SAN BERNARDINO, CA 92404-5117		CLAIMANT	
VITTITOW ARNETTA	2697 BEARCAT DR	LAS CRUCES, NM 88001-1598		CLAIMANT	

Mer	Twp	Rng	Sec	Quadrant	District/Field Office	County
14	0040N	0210W	026	NW	YUMA FO	LA PAZ
14	0040N	0210W	027	NE	YUMA FO	LA PAZ

Act Date	Code	Action	Action Remarks	Receipt Number
02/14/1996	403	LOCATION DATE		
02/15/1996	395	RECORDATION NOTICE RECD		
08/11/2014	782	MAINTENANCE FEE PAYMENT	2016;\$155	3098100
08/11/2014	782	MAINTENANCE FEE PAYMENT	2015;\$155	3098758
08/15/2013	682	MAINTENANCE FEE/\$140	2014;\$140	2856514
08/29/2012	682	MAINTENANCE FEE/\$140	2013;\$140	2644347
08/26/2011	682	MAINTENANCE FEE/\$140	2012	2416783
08/13/2010	682	MAINTENANCE FEE/\$140	2011	2190531
08/20/2009	682	MAINTENANCE FEE/\$140	2010	1982781
08/06/2008	582	MAINTENANCE FEE/\$125	2009	1755217
08/13/2007	582	MAINTENANCE FEE/\$125	2008	1542120
08/14/2006	582	MAINTENANCE FEE/\$125	2007	1334624
08/09/2005	582	MAINTENANCE FEE/\$125	2006	1124661
08/03/2004	582	MAINTENANCE FEE/\$125	2005	920621
08/11/2003	482	MAINTENANCE FEE/\$100	2004	727667
08/12/2002	482	MAINTENANCE FEE/\$100	2003	538435
08/25/2001	482	MAINTENANCE FEE/\$100	2002	365053
08/26/2000	482	MAINTENANCE FEE/\$100	2001	187141
08/23/1999	482	MAINTENANCE FEE/\$100	2000	
08/26/1998	482	MAINTENANCE FEE/\$100	1999	
08/14/1997	482	MAINTENANCE FEE/\$100	1998	
08/23/1996	482	MAINTENANCE FEE/\$100	1997	
02/15/1996	482	MAINTENANCE FEE/\$100	1996	

**NO WARRANTY IS MADE BY BLM  
FOR USE OF THE DATA FOR  
PURPOSES NOT INTENDED BY BLM**



DEPARTMENT OF THE INTERIOR  
BUREAU OF LAND MANAGEMENT  
MINING CLAIMS

Run Date/Time: 08/19/2014 11:03 AM

(LIVE) Serial Register Page

Page 2 of 2

08/11/2014	392	MONIES RECEIVED	\$155.00;1	3098100
08/07/2001	396	TRF OF INTEREST FILED	VITTITOW BILL	365053
08/24/1999	113	ADDITIONAL INFO RECEIVED	RECEIPT 2296783	
08/27/1998	113	ADDITIONAL INFO RECEIVED	RECEIPT 2389712	
08/14/1997	113	ADDITIONAL INFO RECEIVED	RECEIPT 2315305	
08/23/1996	113	ADDITIONAL INFO RECEIVED	RECEIPT 2263362	
02/15/1996	501	ACCT ADV IN LEAD FILE	AMC338267	
02/15/1996	669	LAND STATUS CHECKED		
02/14/1996	404	COUNTY RECORDATION	9600971	

Line Nr Remarks

---

NO WARRANTY IS MADE BY BLM  
FOR USE OF THE DATA FOR  
PURPOSES NOT INTENDED BY BLM

UNITED STATES  
DEPARTMENT OF THE INTERIOR  
BUREAU OF LAND MANAGEMENT

338267

**CREDIT CARD PAYMENT**  
**For Mining Claim Maintenance Fee**

THIS IS A CHANGE OF ADDRESS

TELEPHONE SUBMISSION - ACCURACY OF THE BELOW INFORMATION IS THE RESPONSIBILITY OF THE CLAIMANT/OWNER

NAME MELVIN E. SHUCKEY  
ADDRESS 649 E. 16TH ST  
CITY SAN BERNARDINO STATE CA ZIP 92404  
PHONE # 909 - 885 6095

SEND RECEIPT TO  Above address  
 Other (Include Name and Mailing Address):  
\_\_\_\_\_  
\_\_\_\_\_  
\_\_\_\_\_

AMC NUMBER 338267 CLAIM/SITE NAME WYNWARRA 20  
\_\_\_\_\_  
\_\_\_\_\_

1 # of Claim/Site  
x 140.00 Each  
20 \$ 190.00 Total Charged MSH (INITIALS)

RECEIPT # 2856514

DATE STAMP

RECEIVED  
BLMAZ STATE OFFICE  
2013 AUG 15 P 2:15  
PHOENIX, ARIZONA

\*\*\*\* FOR OFFICIAL USE ONLY \*\*\*\*  
DATE 8-23-13 INITIALS RE VERIFIED \_\_\_\_\_

**United States Department of the Interior  
Bureau of Land Management  
LANDS/RECREATION & PLANNING  
ONE N CENTRAL AVE  
PHOENIX, AZ 85004 -2203  
Phone: 602-417-9200**

Receipt

No: 2856514

<b>Transaction #:</b> 2942323	
<b>Date of Transaction:</b> 08/15/2013	
<b>CUSTOMER:</b>	
MELVIN E SHOCKEY 649 E 16TH ST SAN BERNARDINO, CA 92404-5117 US	

LINE #	QTY	DESCRIPTION	REMARKS	UNIT PRICE	TOTAL
1	1.00	LOCATABLE MINERALS / MINING CLAIMS- NOT NEW-UNADJUD, ONE AUTH NO. ONLY / MINING CLAIM MONEY RECEIVED CASES: AMC338267/\$140.00	MAINT 2014/1	- n/a -	140.00
<b>TOTAL:</b>					<b>\$140.00</b>

PAYMENT INFORMATION			
NOTE: Items will appear on credit card statement as "Bureau of Land Mgmt CO".			
1	AMOUNT:	140.00	POSTMARKED: N/A
	TYPE:	CREDIT CARD	RECEIVED: 08/15/2013
	NAME:	SHOCKEY, MELVIN E 649 E 16TH ST SAN BERNARDINO CA 92404-5117 US	
	CARD NO:	XXXXXXXXXXXX1419	AUTH CODE: 035645
	NAME ON CARD:	MELVIN E SHOCKEY	
	EXPIRES:	06/2015	
	SIGNATURE:		

REMARKS

This receipt was generated by the automated BLM Collections and Billing System and is a paper representation of a portion of the official electronic record contained therein.

UNITED STATES  
DEPARTMENT OF THE INTERIOR  
BUREAU OF LAND MANAGEMENT

Amc 338267

**CREDIT CARD PAYMENT**  
For Mining Claim Maintenance Fee

THIS IS A CHANGE OF ADDRESS

TELEPHONE SUBMISSION - ACCURACY OF THE BELOW INFORMATION IS THE RESPONSIBILITY OF THE CLAIMANT/OWNER

NAME MELVIN E. SHOCKEY  
ADDRESS 649 E 16TH ST  
CITY SAN BERNARDINO STATE CA ZIP 92404  
PHONE # 909 - 885 6095

SEND RECEIPT TO  Above address  
 Other (include Name and Mailing Address):

\_\_\_\_\_  
\_\_\_\_\_  
\_\_\_\_\_

AMC NUMBER  
338267

CLAIM/SITE NAME  
WYNWARRA

1 # of Claim/Site  
x 140.00 Each  
\$ 140 Total Charged MSH (INITIALS)

RECEIPT # 2644347

DATE STAMP  
RECEIVED  
BLM AZ STATE OFFICE  
PHOENIX, ARIZONA  
2012 AUG 29 P 1:35

ENTERED INTO COMPUTER  
9/8/12 AT

\*\*\*\*\* FOR OFFICIAL USE ONLY \*\*\*\*\*  
DATE \_\_\_\_\_ INITIALS \_\_\_\_\_ VERIFIED \_\_\_\_\_

**United States Department of the Interior  
Bureau of Land Management  
LANDS/RECREATION & PLANNING  
ONE N CENTRAL AVE  
PHOENIX, AZ 85004 -2203  
Phone: 602-417-9200**

Receipt

No: 2644347

<b>Transaction #:</b> 2725094	
<b>Date of Transaction:</b> 08/29/2012	
<b>CUSTOMER:</b>	
MELVIN E SHOCKEY 649 E 16TH ST SAN BERNARDINO, CA 92404-5117 US	

LINE #	QTY	DESCRIPTION	REMARKS	UNIT PRICE	TOTAL
1	1.00	LOCATABLE MINERALS / MINING CLAIMS- NOT NEW-UNADJUD, ONE AUTH NO. ONLY / MINING CLAIM MONEY RECEIVED CASES: AMC338267/\$140.00	MAINT 2013/1	- n/a -	140.00
<b>TOTAL:</b>					<b>\$140.00</b>

PAYMENT INFORMATION			
NOTE: Items will appear on credit card statement as "Bureau of Land Mgmt CO".			
1	AMOUNT:	140.00	POSTMARKED: N/A
	TYPE:	CREDIT CARD	RECEIVED: 08/29/2012
	NAME:	SHOCKEY, MELVIN E 649 E 16TH ST SAN BERNARDINO CA 92404-5117 US	
	CARD NO:	XXXXXXXXXXXX2707	AUTH CODE: 02518C
	NAME ON CARD:	MELVIN E SHOCKEY	
	EXPIRES:	06/2014	
	SIGNATURE:		

REMARKS

This receipt was generated by the automated BLM Collections and Billing System and is a paper representation of a portion of the official electronic record contained therein.

UNITED STATES  
DEPARTMENT OF THE INTERIOR  
BUREAU OF LAND MANAGEMENT

Amc338267

**CREDIT CARD PAYMENT**  
**For Mining Claim Maintenance Fee**

THIS IS A CHANGE OF ADDRESS

TELEPHONE SUBMISSION - ACCURACY OF THE BELOW INFORMATION IS THE RESPONSIBILITY OF THE CLAIMANT/OWNER

NAME MEL Shockey  
ADDRESS 649 E 16<sup>th</sup> ST ✓  
CITY SAN Bernadino STATE CA ZIP 92404  
PHONE # 909 - 885 - 6095

SEND RECEIPT TO  Above address  
 Other (Include Name and Mailing Address):

\_\_\_\_\_  
\_\_\_\_\_  
\_\_\_\_\_

AMC NUMBER  
338267

CLAIM/SITE NAME  
WYN Warra  
ENTERED INTO COMPUTER  
AUG 20 2010

1 # of Claim/Site  
x 140.00 Each  
\$ 140<sup>00</sup> Total Charged SC (INITIALS)

RECEIPT # 2190531

DATE STAMP

RECEIVED  
BLM AZ STATE OFFICE  
2010 AUG 12 A 10:24  
PHOENIX, ARIZONA

\*\*\*\*\* FOR OFFICIAL USE ONLY \*\*\*\*\*

DATE \_\_\_\_\_ INITIALS \_\_\_\_\_ VERIFIED \_\_\_\_\_

**United States Department of the Interior**  
**Bureau of Land Management**  
 LANDS/RECREATION & PLANNING  
 ONE N CENTRAL AVE  
 PHOENIX, AZ 85004 -2203  
 Phone:

Receipt

No: 2190531

ENTERED INTO COMPUTER

<b>Transaction #:</b> 2260264	
<b>Date of Transaction:</b> 08/13/2010	
<b>CUSTOMER:</b>	MELVIN E SHOCKEY 649 E 16TH ST SAN BERNARDINO, CA 92404-5117 US
	AUG 20 2010

LINE #	QTY	DESCRIPTION	REMARKS	UNIT PRICE	TOTAL
1	1.00	LOCATABLE MINERALS / MINING CLAIMS- NOT NEW-UNADJUD, ONE AUTH NO. ONLY / MINING CLAIM MONEY RECEIVED CASES: AMC338267/\$140.00	MAINT FEE PYMNT (1) 2011	- n/a -	140.00
<b>TOTAL:</b>					<b>\$140.00</b>

PAYMENT INFORMATION			
NOTE: Items will appear on credit card statement as "Bureau of Land Mgmt CO".			
1	AMOUNT:	140.00	POSTMARKED: N/A
	TYPE:	CREDIT CARD	RECEIVED: 08/13/2010
	NAME:	SHOCKEY, MELVIN E 649 E 16TH ST SAN BERNARDINO CA 92404-5117 US	
	CARD NO:	XXXXXXXXXXXX6148	AUTH CODE: 01594C
	NAME ON CARD:	MELVIN E SHOCKEY	
	EXPIRES:	06/2011	
	SIGNATURE:		

REMARKS

This receipt was generated by the automated BLM Collections and Billing System and is a paper representation of a portion of the official electronic record contained therein.

AMC 338267

UNITED STATES  
DEPARTMENT OF THE INTERIOR  
BUREAU OF LAND MANAGEMENT

**CREDIT CARD PAYMENT**  
**For Mining Claim Maintenance Fee**

THIS IS A CHANGE OF ADDRESS

TELEPHONE SUBMISSION - ACCURACY OF THE BELOW INFORMATION IS THE RESPONSIBILITY OF THE CLAIMANT/OWNER

NAME MELVIN E Shockey  
ADDRESS 649 E. 16th St.  
CITY SAN BER STATE CA ZIP 92404  
PHONE # 909 - 885 6095

SEND RECEIPT TO  Above address  
 Other (Include Name and Mailing Address):

AMC NUMBER  
338267

CLAIM/SITE NAME  
Wynwarra

1 # of Claim/Site  
x 140.00 Each  
\$ 140.00 Total Charged SC (INITIALS)

RECEIPT # 1982781

DATE STAMP

RECEIVED  
BLM AZ STATE OFFICE  
2009 AUG -7 P 3:25  
PHOENIX, ARIZONA

ENTERED INTO COMPUTER \*\*\*\*\* FOR OFFICIAL USE ONLY \*\*\*\*\*  
DATE AUG 24 2009 INITIALS ps VERIFIED



**United States Department of the Interior**  
**Bureau of Land Management**  
 BUSINESS & SUPPORT SVCS DIV  
 ONE N CENTRAL AVE SUITE 800  
 PHOENIX, AZ 85004 -4427  
 Phone: (602) 417-9200

Receipt

No: 1982781

<b>Transaction #:</b> 2046843		<b>ENTERED INTO COMPUTER</b>
<b>Date of Transaction:</b> 08/20/2009		
<b>CUSTOMER:</b>	MELVIN E SHOCKEY 649 E 16TH ST SAN BERNARDINO, CA 92404-5117 US	AUG 24 2009 <i>BB</i>

LINE #	QTY	DESCRIPTION	REMARKS	UNIT PRICE	TOTAL
1	1.00	LOCATABLE MINERALS / MINING CLAIMS-NOT NEW-UNADJUD, ONE AUTH NO. ONLY / MINING CLAIM MONEY RECEIVED CASES: AMC338267/\$140.00	MAINT (1)	- n/a -	140.00
<b>TOTAL:</b>					<b>\$140.00</b>

PAYMENT INFORMATION			
NOTE: Items will appear on credit card statement as "Bureau of Land Mgmt CO".			
1	AMOUNT:	140.00	POSTMARKED: N/A
	TYPE:	CREDIT CARD	RECEIVED: 08/20/2009
	NAME:	SHOCKEY, MELVIN E 649 E 16TH ST SAN BERNARDINO CA 92404-5117 US	
	CARD NO:	XXXXXXXXXXXX6148	AUTH CODE: 01555C
	NAME ON CARD:	MELVIN E SHOCKEY	
	EXPIRES:	06/2011	
	SIGNATURE:		

REMARKS

This receipt was generated by the automated BLM Collections and Billing System and is a paper representation of a portion of the official electronic record contained therein.

AMC 338267

UNITED STATES  
DEPARTMENT OF THE INTERIOR  
BUREAU OF LAND MANAGEMENT

CREDIT CARD PAYMENT  
FOR MINING CLAIM MAINTENANCE FEE

NAME Mel Shockey  
ADDRESS 649 E. 16<sup>th</sup> St.  
CITY San Bernardino STATE CA ZIP 92404  
PHONE # (909) 885-6095

[ ] THIS IS A CHANGE OF ADDRESS

AMC NUMBER CLAIM/SITE NAME

338267

ENTERED INTO COMPUTER

SEP 02 2008 JB

DATE STAMP

COUNT 1 \$ 135 INITIALS JMC

TELEPHONE SUBMISSION - ACCURACY OF THE ABOVE INFORMATION  
IS THE RESPONSIBILITY OF THE CLAIMANT/OWNER

FOR OFFICIAL USE ONLY

DATE INITIALS VERIFIED

PHOENIX, ARIZONA

2008 AUG -6 P 2:01

RECEIVED  
B.L.M. AZ STATE OFFICE

# 1755217

**United States Department of the Interior**  
**Bureau of Land Management**  
 BUSINESS & SUPPORT SVCS DIV  
 ONE N CENTRAL AVE SUITE 800  
 PHOENIX, AZ 85004 -4427  
 Phone: (602) 417-9200

Receipt

No:

1755217

Transaction #: 1812596		<b>ENTERED INTO COMPUTER</b>	
Date of Transaction: 08/06/2008			
CUSTOMER:	MEL SHOCKEY 649 E 16TH ST SAN BERNARDINO, CA 92404	SEP 02 2008	PB <del>1</del> VERIFIED

LINE #	QTY	DESCRIPTION	REMARKS	UNIT PRICE	TOTAL
1	1.00	LOCATABLE MINERALS / MINING CLAIMS-NOT NEW-UNADJUD, ONE AUTH NO. ONLY / MINING CLAIM MONEY RECEIVED (455) CASES: AMC338267/\$125.00	MAINT 2009/1	- n/a -	125.00
<b>TOTAL:</b>					<b>\$125.00</b>

PAYMENT INFORMATION			
NOTE: Items will appear on credit card statement as "Bureau of Land Mgmt CO".			
1	AMOUNT:	\$125.00	POSTMARKED: N/A
	TYPE:	CREDIT CARD	RECEIVED: 08/06/2008
	NAME:	SHOCKEY, MEL 649 E 16TH ST SAN BERNARDINO CA 92404	
	CARD NO:	XXXXXXXXXXXX6148	AUTH CODE: 04508C
	NAME ON CARD:	MEL SHOCKEY	
	EXPIRES:	06/30/2011	
	SIGNATURE:		

REMARKS

This receipt was generated by the automated BLM Collections and Billing System and is a paper representation of a portion of the official electronic record contained therein.

MC 338267

UNITED STATES  
DEPARTMENT OF THE INTERIOR  
BUREAU OF LAND MANAGEMENT

CREDIT CARD PAYMENT  
FOR MINING CLAIM MAINTENANCE FEE

NAME Melvin E. Speckey  
ADDRESS 649 E. 16th St.  
CITY San Bernardino STATE CA ZIP 92404  
PHONE # (909) 885-6095

SEND RECEIPT TO ABOVE ADDRESS   
SEND RECEIPT TO: \_\_\_\_\_  
\_\_\_\_\_  
\_\_\_\_\_

AMC NUMBER 338267 CLAIM/SITE NAME Wynwarra  
\_\_\_\_\_  
\_\_\_\_\_

DATE STAMP

PHOENIX, ARIZONA  
2007 AUG 13 A 9:25  
RECEIVED  
B.L.M. AZ STATE OFFICE

TELEPHONE SUBMISSION - ACCURACY OF THE ABOVE INFORMATION  
IS THE RESPONSIBILITY OF THE CLAIMANT/OWNER

FOR OFFICIAL USE ONLY

DATE \_\_\_\_\_ INITIALS \_\_\_\_\_ VERIFIED \_\_\_\_\_  
COUNT 1 \$ 125 INITIALS MC  
#1542120

**United States Department of the Interior**  
**Bureau of Land Management**  
 BUSINESS & SUPPORT SVCS DIV  
 ONE N CENTRAL AVE SUITE 800  
 PHOENIX, AZ 85004 -4427  
 Phone: (602) 417-9200

Receipt

No: 1542120

<b>Transaction #:</b> 1593473	
<b>Date of Transaction:</b> 08/13/2007	
<b>CUSTOMER:</b>	MELVIN E SHOCKEY 649 E 16TH ST SAN BERNARDINO,CA 92404

LINE #	QTY	DESCRIPTION	REMARKS	UNIT PRICE	TOTAL
1	1.00	LOCATABLE MINERALS / MINING CLAIMS- NOT NEW-UNADJUD,ONE AUTH NO. ONLY / MINING CLAIM MONEY RECEIVED (455) <b>CASES: AMC338267/\$125.00</b>	MAINT 2008/1	- n/a -	125.00
<b>TOTAL:</b>					<b>\$125.00</b>

PAYMENT INFORMATION			
NOTE: Items will appear on credit card statement as "Bureau of Land Management".			
1	AMOUNT:	\$125.00	POSTMARKED: N/A
	TYPE:	CREDIT CARD	RECEIVED: 08/13/2007
	NAME:	SHOCKEY, MELVIN E 649 E 16TH ST SAN BERNARDINO CA 92404	
	CARD NO:	XXXXXXXXXXXX0164	AUTH CODE: 02554B
	NAME ON CARD:	MELVIN E SHOCKEY	
	EXPIRES:	06/30/2008	
	SIGNATURE:		

REMARKS

This receipt was generated by the automated BLM Collections and Billing System and is a paper representation of a portion of the official electronic record contained therein.

United States Department of the Interior  
 Bureau of Land Management  
 BUSINESS & SUPPORT SVCS DIV  
 ONE N CENTRAL AVE  
 PHOENIX, AZ 85004 -2203  
 Phone: (602) 417-9200

Receipt

No: 1334624

<b>Transaction #:</b> 1379715	
<b>Date of Transaction:</b> 08/15/2006	
<b>CUSTOMER:</b>	MELVIN E SHOCKEY 649 E 16TH ST SAN BERNADINO,CA 92404

AMC 338267

LINE #	QTY	DESCRIPTION	REMARKS	UNIT PRICE	TOTAL
1	1.00	LOCATABLE MINERALS / MINING CLAIMS-NOT NEW-UNADJUD,ONE AUTH NO. ONLY / MINING CLAIM MONEY RECEIVED (455) CASES: AMC338267/\$125.00	MAINT 2007 (1)	- n/a -	125.00
<b>TOTAL:</b>					<b>\$125.00</b>

PAYMENT INFORMATION			
NOTE: Items will appear on credit card statement as "Bureau of Land Management".			
1	AMOUNT:	\$125.00	POSTMARKED: N/A
	TYPE:	CREDIT CARD	RECEIVED: 08/15/2006
	NAME:	SHOCKEY, MELVIN E 649 E 16TH ST SAN BERNADINO CA 92404	
	CARD NO:	XXXXXXXXXXXX0164	AUTH CODE: 05446B
	NAME ON CARD:	MELVIN E SHOCKEY	
	EXPIRES:	06/30/2008	
	SIGNATURE:		

REMARKS

This receipt was generated by the automated BLM Collections and Billing System and is a paper representation of a portion of the official electronic record contained therein.

RE 8/21/06  
 ENTERED IN COMPUTER

UNITED STATES  
DEPARTMENT OF THE INTERIOR  
BUREAU OF LAND MANAGEMENT

CREDIT CARD PAYMENT  
FOR MINING CLAIM MAINTENANCE FEE

NAME Mel Shockey

ADDRESS 649 E. 16th St

CITY San Bernardino STATE CA ZIP 92404

PHONE # (909) 885-6095

THIS IS A CHANGE OF ADDRESS

AMC NUMBER

CLAIM/SITE NAME

338267

Wynwarra

DATE STAMP

COUNT 1 \$ 125 INITIALS [Signature]

TELEPHONE SUBMISSION - ACCURACY OF THE ABOVE INFORMATION  
IS THE RESPONSIBILITY OF THE CLAIMANT/OWNER

FOR OFFICIAL USE ONLY

DATE

INITIALS

VERIFIED

ARIZONA  
STATE OFFICE  
PHOENIX, ARIZONA

2006 AUG 14 P 2:33

RECEIVED  
BUREAU OF  
LAND MANAGEMENT

**United States Department of the Interior**  
**Bureau of Land Management**  
 BUSINESS & SUPPORT SVCS DIV  
 222 N CENTRAL AVE  
 PHOENIX, AZ 85004 -2203  
 Phone: (602) 417-9200

Receipt	
No:	1124661

<b>Transaction #:</b> 1163621
<b>Date of Transaction:</b> 08/09/2005
<i>AMC 338267</i>
<b>CUSTOMER:</b> MEL SHOCKEY 649 E 16TH ST SAN BERNARDINO, CA 92404

LINE #	QTY	DESCRIPTION	REMARKS	UNIT PRICE	TOTAL
1	1.00	LOCATABLE MINERALS / MINING CLAIMS-NOT NEW-UNADJUD, ONE AUTH NO. ONLY / MINING CLAIM MONEY RECEIVED (455) CASES: AMC338267/\$125.00	MAINT 2006/1	- n/a -	125.00
<b>TOTAL:</b>					<b>\$125.00</b>

PAYMENT INFORMATION																													
NOTE: Items will appear on credit card statement as "Bureau of Land Management".																													
1	<table border="1"> <tr> <td>AMOUNT:</td> <td>\$125.00</td> <td>POSTMARKED:</td> <td>N/A</td> </tr> <tr> <td>TYPE:</td> <td>CREDIT CARD</td> <td>RECEIVED:</td> <td>08/09/2005</td> </tr> <tr> <td>NAME:</td> <td colspan="3">SHOCKEY, MEL 649 E 16TH ST SAN BERNARDINO CA 92404</td> </tr> <tr> <td>CARD NO:</td> <td>XXXXXXXXXXXX0164</td> <td>AUTH CODE:</td> <td>005795</td> </tr> <tr> <td>NAME ON CARD:</td> <td colspan="3">MEL SHOCKEY</td> </tr> <tr> <td>EXPIRES:</td> <td colspan="3">06/30/2008</td> </tr> <tr> <td>SIGNATURE:</td> <td colspan="3"></td> </tr> </table>	AMOUNT:	\$125.00	POSTMARKED:	N/A	TYPE:	CREDIT CARD	RECEIVED:	08/09/2005	NAME:	SHOCKEY, MEL 649 E 16TH ST SAN BERNARDINO CA 92404			CARD NO:	XXXXXXXXXXXX0164	AUTH CODE:	005795	NAME ON CARD:	MEL SHOCKEY			EXPIRES:	06/30/2008			SIGNATURE:			
AMOUNT:	\$125.00	POSTMARKED:	N/A																										
TYPE:	CREDIT CARD	RECEIVED:	08/09/2005																										
NAME:	SHOCKEY, MEL 649 E 16TH ST SAN BERNARDINO CA 92404																												
CARD NO:	XXXXXXXXXXXX0164	AUTH CODE:	005795																										
NAME ON CARD:	MEL SHOCKEY																												
EXPIRES:	06/30/2008																												
SIGNATURE:																													

REMARKS

This receipt was generated by the automated BLM Collections and Billing System and is a paper representation of a portion of the official electronic record contained therein.

ENTERED IN COMPUTER  
*RE 8/15/05*



UNITED STATES  
DEPARTMENT OF THE INTERIOR  
BUREAU OF LAND MANAGEMENT

CREDIT CARD PAYMENT  
FOR MINING CLAIM MAINTENANCE FEE

NAME Mel Shockey  
ADDRESS 649 E. 16th St.  
CITY San STATE CA ZIP 92404  
PHONE # (909) 885-6095

SEND RECEIPT TO ABOVE ADDRESS

SEND RECEIPT TO: \_\_\_\_\_  
\_\_\_\_\_  
\_\_\_\_\_

AMC NUMBER

338267

CLAIM/SITE NAME

Wynwarra

DATE STAMP

RECEIVED  
B.L.M. AZ STATE OFFICE  
2005 AUG -9 P 12:00  
PHOENIX, ARIZONA

TELEPHONE SUBMISSION - ACCURACY OF THE ABOVE INFORMATION  
IS THE RESPONSIBILITY OF THE CLAIMANT/OWNER

FOR OFFICIAL USE ONLY

ENTERED BY COMPUTER

DATE INITIALS VERIFIED

COUNT 1 \$ 125 INITIALS mc

UNITED STATES  
DEPARTMENT OF THE INTERIOR  
BUREAU OF LAND MANAGEMENT

CREDIT CARD PAYMENT  
FOR MINING CLAIM MAINTENANCE FEE

AMC 338267

NAME Melvin E. ~~Ed~~ Shockey

ADDRESS 649 E. 16th St.

CITY San Bernadino STATE CA ZIP 92404

PHONE # (909) 885-6095

SEND RECEIPT TO ABOVE ADDRESS

SEND RECEIPT TO: \_\_\_\_\_  
\_\_\_\_\_  
\_\_\_\_\_

AMC NUMBER	CLAIM/SITE NAME	Amount
<u>338267</u>	<u>Wynwarra</u>	<u>\$125.00</u>
_____	_____	_____
_____	_____	_____

DATE STAMP

PHOENIX, ARIZONA  
2004 AUG - 3 P 2:01  
RECEIVED  
BLM, AZ STATE OFFICE

TELEPHONE SUBMISSION - ACCURACY OF THE ABOVE INFORMATION  
IS THE RESPONSIBILITY OF THE CLAIMANT/OWNER

FOR OFFICIAL USE ONLY

8/3/04 DATE [Signature] INITIALS VERIFIED

COUNT 1 \$ 125.00 INITIALS [Signature]

ENTERED IN COMPUTER

[Signature] 8/31/04

**United States Department of the Interior**  
**Bureau of Land Management**  
 BUSINESS & SUPPORT SVCS DIV  
 222 N CENTRAL AVE  
 PHOENIX, AZ 85004 -2203  
 Phone: (602) 417-9200

Receipt	
No:	920621

**Transaction #:** 954698  
**Date of Transaction:** 08/03/2004

<b>CUSTOMER:</b>	MELVIN E SHOCKEY 649 E 16TH ST SAN BERNADINO, CA 92404
------------------	--

LINE #	QTY	DESCRIPTION	REMARKS	UNIT PRICE	TOTAL
1	1.00	LOCATABLE MINERALS / MINING CLAIMS-NOT NEW-UNADJUD, ONE AUTH NO. ONLY / MINING CLAIM MONEY RECEIVED (455) <b>CASES:</b> AMC338267/\$125.00	MAIN 2005 (1)	- n/a -	125.00
<b>TOTAL:</b>					<b>\$125.00</b>

PAYMENT INFORMATION																													
NOTE: Items will appear on credit card statement as "Bureau of Land Management".																													
1	<table border="1"> <tr> <td><b>AMOUNT:</b></td> <td>\$125.00</td> <td><b>POSTMARKED:</b></td> <td>N/A</td> </tr> <tr> <td><b>TYPE:</b></td> <td>CREDIT CARD</td> <td><b>RECEIVED:</b></td> <td>08/03/2004</td> </tr> <tr> <td><b>NAME:</b></td> <td colspan="3">SHOCKEY, MELVIN E 649 E 16TH ST SAN BERNADINO CA 92404</td> </tr> <tr> <td><b>CARD NO:</b></td> <td>XXXXXXXXXXXX5126</td> <td><b>AUTH CODE:</b></td> <td>019762</td> </tr> <tr> <td><b>NAME ON CARD:</b></td> <td colspan="3">MELVIN E. SHOCKEY</td> </tr> <tr> <td><b>EXPIRES:</b></td> <td colspan="3">02/28/2005</td> </tr> <tr> <td><b>SIGNATURE:</b></td> <td colspan="3"></td> </tr> </table>	<b>AMOUNT:</b>	\$125.00	<b>POSTMARKED:</b>	N/A	<b>TYPE:</b>	CREDIT CARD	<b>RECEIVED:</b>	08/03/2004	<b>NAME:</b>	SHOCKEY, MELVIN E 649 E 16TH ST SAN BERNADINO CA 92404			<b>CARD NO:</b>	XXXXXXXXXXXX5126	<b>AUTH CODE:</b>	019762	<b>NAME ON CARD:</b>	MELVIN E. SHOCKEY			<b>EXPIRES:</b>	02/28/2005			<b>SIGNATURE:</b>			
<b>AMOUNT:</b>	\$125.00	<b>POSTMARKED:</b>	N/A																										
<b>TYPE:</b>	CREDIT CARD	<b>RECEIVED:</b>	08/03/2004																										
<b>NAME:</b>	SHOCKEY, MELVIN E 649 E 16TH ST SAN BERNADINO CA 92404																												
<b>CARD NO:</b>	XXXXXXXXXXXX5126	<b>AUTH CODE:</b>	019762																										
<b>NAME ON CARD:</b>	MELVIN E. SHOCKEY																												
<b>EXPIRES:</b>	02/28/2005																												
<b>SIGNATURE:</b>																													

REMARKS

This receipt was generated by the automated BLM Collections and Billing System and is a paper representation of a portion of the official electronic record contained therein.

UNITED STATES  
DEPARTMENT OF THE INTERIOR  
BUREAU OF LAND MANAGEMENT

CREDIT CARD PAYMENT  
FOR MINING CLAIM MAINTENANCE FEE

AMC 338267

NAME Melvin E. Shockay

ADDRESS 649 E. 16<sup>th</sup> St.

CITY San Bernadino STATE CA ZIP 92404

PHONE # (909) 885-6095

SEND RECEIPT TO ABOVE ADDRESS

SEND RECEIPT TO: \_\_\_\_\_  
\_\_\_\_\_  
\_\_\_\_\_

AMC NUMBER

CLAIM/SITE NAME

338267

Wynwarra

DATE STAMP

COUNT 1 \$ 100.<sup>00</sup> INITIALS MS

TELEPHONE SUBMISSION - ACCURACY OF THE ABOVE INFORMATION  
IS THE RESPONSIBILITY OF THE CLAIMANT/OWNER

FOR OFFICIAL USE ONLY

8/21/2003  
DATE

RE  
INITIALS

TES ✓  
VERIFIED

PHOENIX, ARIZONA  
2003 AUG 11 P 2: 54  
RECEIVED  
B.L.M. AZ STATE OFFICE

**United States Department of the Interior**  
**Bureau of Land Management**  
 BUSINESS & SUPPORT SVCS DIV  
 222 N CENTRAL AVE  
 PHOENIX, AZ 85004 -2203  
 Phone: (602) 417-9200

Receipt	
No:	727667

<b>Transaction #:</b> 757013
<b>Date of Transaction:</b> 08/11/2003
<b>CUSTOMER:</b> MELVIN E SHOCKY 649 E. 16TH STREET SAN BERNARDINO, CA 92404

LINE #	QTY	DESCRIPTION	REMARKS	UNIT PRICE	TOTAL
1	1.00	LOCATABLE MINERALS / MINING CLAIMS-NOT NEW-UNADJUD, ONE AUTH NO. ONLY / MINING CLAIM MONEY RECEIVED (455) <b>CASES: AMC338267/\$100.00</b>	MAINT 2004 (1)	- n/a -	100.00
<b>TOTAL:</b>					<b>\$100.00</b>

PAYMENT INFORMATION																													
NOTE: Items will appear on credit card statement as "Bureau of Land Management".																													
1	<table border="1"> <tr> <td>AMOUNT:</td> <td>\$100.00</td> <td>POSTMARKED:</td> <td>N/A</td> </tr> <tr> <td>TYPE:</td> <td>CREDIT CARD</td> <td>RECEIVED:</td> <td>08/11/2003</td> </tr> <tr> <td>NAME:</td> <td colspan="3">SHOCKY, MELVIN E 649 E. 16TH STREET SAN BERNARDINO CA 92404</td> </tr> <tr> <td>CARD NO:</td> <td>XXXXXXXXXXXX5126</td> <td>AUTH CODE:</td> <td>000110</td> </tr> <tr> <td>NAME ON CARD:</td> <td colspan="3">SHOCKY, MELVIN E.</td> </tr> <tr> <td>EXPIRES:</td> <td colspan="3">02/28/2005</td> </tr> <tr> <td>SIGNATURE:</td> <td colspan="3"></td> </tr> </table>	AMOUNT:	\$100.00	POSTMARKED:	N/A	TYPE:	CREDIT CARD	RECEIVED:	08/11/2003	NAME:	SHOCKY, MELVIN E 649 E. 16TH STREET SAN BERNARDINO CA 92404			CARD NO:	XXXXXXXXXXXX5126	AUTH CODE:	000110	NAME ON CARD:	SHOCKY, MELVIN E.			EXPIRES:	02/28/2005			SIGNATURE:			
AMOUNT:	\$100.00	POSTMARKED:	N/A																										
TYPE:	CREDIT CARD	RECEIVED:	08/11/2003																										
NAME:	SHOCKY, MELVIN E 649 E. 16TH STREET SAN BERNARDINO CA 92404																												
CARD NO:	XXXXXXXXXXXX5126	AUTH CODE:	000110																										
NAME ON CARD:	SHOCKY, MELVIN E.																												
EXPIRES:	02/28/2005																												
SIGNATURE:																													

REMARKS

This receipt was generated by the automated BLM Collections and Billing System and is a paper representation of a portion of the official electronic record contained therein.



#538435

UNITED STATES  
DEPARTMENT OF THE INTERIOR  
BUREAU OF LAND MANAGEMENT

CREDIT CARD PAYMENT  
FOR MINING CLAIM MAINTENANCE FEE

NAME Melvin E. Shockey  
ADDRESS 649 E. 16th St.  
CITY San Bernardino STATE CA ZIP 92404  
PHONE # (909) 885-6095

SEND RECEIPT TO ABOVE ADDRESS [ ]  
SEND RECEIPT TO: \_\_\_\_\_  
\_\_\_\_\_  
\_\_\_\_\_

AMC NUMBER 338267 CLAIM/SITE NAME Wynyarra  
\_\_\_\_\_  
\_\_\_\_\_

DATE STAMP \_\_\_\_\_ COUNT 1 \$ 100.<sup>00</sup> INITIALS MSC

TELEPHONE SUBMISSION - ACCURACY OF THE ABOVE INFORMATION  
IS THE RESPONSIBILITY OF THE CLAIMANT/OWNER

PHOENIX, ARIZONA  
2002 AUG 12 P 2:18  
RECEIVED  
B.L.M. AZ STATE OFFICE

FOR OFFICIAL USE ONLY  
DATE \_\_\_\_\_ INITIALS \_\_\_\_\_ VERIFIED \_\_\_\_\_

ENTERED INTO COMPUTER  
9/14/02 AB

**United States Department of the Interior**  
**Bureau of Land Management**  
 BUSINESS & SUPPORT SVCS DIV  
 222 N CENTRAL AVE  
 PHOENIX, AZ 85004 -2203  
 Phone: (602) 417-9200

Receipt	
No:	538435

<b>Transaction #:</b> 562902	
<b>Date of Transaction:</b> 08/12/2002	
<b>CUSTOMER:</b>	MELVIN E SHOCKEY 649 E 16TH ST SAN BERNARDINO, CA 92404

LINE #	QTY	DESCRIPTION	REMARKS	UNIT PRICE	TOTAL
1	1.00	LOCATABLE MINERALS / MINING CLAIMS-NOT NEW-UNADJUD, ONE AUTH NO. ONLY / MINING CLAIM MONEY RECEIVED (455) CASES: AMC338267/\$100.00	MAINT 2003 (1)	- n/a -	100.00
<b>TOTAL:</b>					<b>\$100.00</b>

PAYMENT INFORMATION			
NOTE: Items will appear on credit card statement as "Bureau of Land Management".			
1	AMOUNT:	\$100.00	POSTMARKED: N/A
	TYPE:	CREDIT CARD	RECEIVED: 08/12/2002
	NAME:	SHOCKEY, MELVIN E 649 E 16TH ST SAN BERNARDINO CA 92404	
	CARD NO:	XXXXXXXXXXXX5126	AUTH CODE: 047484
	NAME ON CARD:	MELVIN E SHOCKEY	
	EXPIRES:	02/28/2005	
	SIGNATURE:		

REMARKS

This receipt was generated by the automated BLM Collections and Billing System and is a paper representation of a portion of the official electronic record contained therein.





RETURN Requested

by

MEL Shockey  
49 EAST 16TH ST.  
SAN BERNARDINO, CA 92404



2001-03524

Page 1 of 1  
Requested By: MELVIN SHOCKEY  
PATRICIA L WALL, RECORDER  
OFFICIAL RECORDS OF LA PAZ COUNTY, AZ  
08/20/2001 03:29 PM Recording Fee \$10.00

MAINTENANCE FEE PAYMENT

\$100.00 MAINTENANCE FEE PAYMENT DUE ON OR BEFORE AUGUST 31, 2001  
IN LIEU OF ASSESSMENT WORK FOR THE UPCOMING ASSESSMENT  
YEAR BEGINNING SEPTEMBER 1 OF THE YEAR NOTED ABOVE.

BUREAU OF LAND MANAGEMENT  
ARIZONA STATE OFFICE  
222 NORTH CENTRAL AVENUE  
PHOENIX, AZ 85004

COUNT: 1 \$ 100 INT: C FOR  
OFFICIAL USE ONLY

THE CLAIMS ARE SITUATED IN La Paz COUNTY, ARIZONA.

BLM SERIAL NUMBERS

NAMES OF CLAIMS OR SITES

A MC 338267 THRU A MC \_\_\_\_\_  
COUNTY BOOK/DOCKET \_\_\_\_\_, PAGE(S) OR FEE NO(S) \_\_\_\_\_

A MC \_\_\_\_\_ THRU A MC \_\_\_\_\_  
COUNTY BOOK/DOCKET \_\_\_\_\_, PAGE(S) OR FEE NO(S) 90-00971

(OR) IF NOT CONSECUTIVE NUMBERS LIST SEPARATELY BELOW:

BLM SERIAL NUMBERS	NAME OF CLAIMS/SITES	COUNTY BOOK/DOCKET & PAGE OR FEE NUMBER
A MC _____	_____	_____
A MC _____	_____	_____
A MC _____	_____	_____
A MC _____	_____	_____
A MC _____	_____	_____
A MC _____	_____	_____
A MC _____	_____	_____
A MC _____	_____	_____
A MC _____	_____	_____
A MC _____	_____	_____
A MC _____	_____	_____
A MC _____	_____	_____
A MC _____	_____	_____
A MC _____	_____	_____
A MC _____	_____	_____

CLAIMANT'S NAME: MELVIN/SUSAN Shockey

ADDRESS: 649 EAST 16TH ST. CITY: SAN BERNARDINO STATE: CA ZIP: 92404

CHECK HERE IF THIS IS A CHANGE OF ADDRESS

PHONE: (909) 885 6095

SIGNATURE: Melvin E. Shockey  
TO RECORD WITH THE COUNTY, ONE CLAIMANT OR THE AGENT MUST SIGN

LIST ALL ADDITIONAL OWNERS ON REVERSE SIDE OF THIS FORM

FOR OFFICIAL USE ONLY  
ENTERED INTO COMPUTER: 10/2/01 TK  
DATE INITIALS VERIFIED

2001 AUG 24 A 4:46  
TIME STAMP  
RECEIVED  
BUREAU OF LAND MANAGEMENT  
PHOENIX, ARIZONA

**United States Department of the Interior  
Bureau of Land Management**  
BUSINESS & SUPPORT SVCS DIV  
222 N CENTRAL AVE  
PHOENIX, AZ 85004 -2203  
Phone: (602) 417-9200

Receipt	
No:	365053

<b>Transaction #:</b> 383662
<b>Date of Transaction:</b> 08/25/2001
<b>CUSTOMER:</b> M E SHOCKEY 649 E 16TH ST SAN BERNADINO, CA 92404

LINE #	QTY	COMMODITY / SUBJECT / ACTION / PRODUCT	REMARKS	UNIT PRICE	TOTAL
1	1.00	LOCATABLE MINERALS / MINING CLAIMS-NOT NEW-UNADJUD, ONE AUTH NO. ONLY / MINING CLAIM MONEY RECEIVED (455)	TRF (1)	- n/a -	\$5.00
2	1.00	LOCATABLE MINERALS / MINING CLAIMS-NOT NEW-UNADJUD, ONE AUTH NO. ONLY / MINING CLAIM MONEY RECEIVED (455)	MAINT 2002 (1)	- n/a -	\$100.00
3	6.00	IAC PRODUCTS / COPIES / CASEFILE/DOCUMENT COPIES / COPIES (B/W UP TO 11X17)-\$.13/P		\$0.13	\$0.78
4	1.00	IAC PRODUCTS / SERVICE/ADMIN CHARGES / MAILING COSTS / POSTAGE		- n/a -	\$0.22

<b>TOTAL:</b>	<b>\$106.00</b>
---------------	-----------------

PAYMENT INFORMATION			
1	AMOUNT:	\$106.00	POSTMARKED: 08/22/2001
	TYPE:	CHECK	RECEIVED: 08/24/2001
	CHECK NO:	4824	
	NAME:	SHOCKEY, MELVIN E 649 E 16TH ST SAN BERNADINO CA 92404	

REMARKS
PHONE: 909-885-6095

CASE SERIAL NUMBER INFORMATION		
TRNS #	LINE #	CASES
383662	1	AMC338267/\$5.00
383662	2	AMC338267/\$100.00
383662	3	- n/a -
383662	4	- n/a -

This receipt was generated by the automated BLM Collections and Billings System and is a paper representation of a portion of the official electronic record contained therein.



(Mail recording to)

Name MELVIN E. Shockey  
Address 649 East 16th St.  
SAN BERNARDINO, CA.  
92404



FOR RECORDERS USE

QUITCLAIM DEED

DOCUMENTARY TRANSFER TAX \$	
<input type="checkbox"/>	computed on full value of property conveyed, or
<input type="checkbox"/>	computed on full value less value of liens and encumbrances remaining at the time of sale.
Signature of Declarant or Agent Determining Tax.	Firm Name

I/We Bill R. Vittitow  
Name of grantor (s)

The undersigned grantor(s) for a valuable consideration, receipt of which is hereby acknowledged, do hereby remise, release and forever quitclaim to MELVIN E. SHOCKEY AND SUSAN SHOCKE

The following described Mining Claim(s) in the county of LA PAZ State of Arizona  
WYN YARRA

Assessor's parcel No \_\_\_\_\_ AMC# 338267 T. 4N R. 21W Sec 27/86 MDM

Executed on August 7<sup>th</sup>, 192001 at Las Cruces, NM dei  
(City and State)

Signature(s) \_\_\_\_\_  
STATE OF NEW MEXICO } SS  
COUNTY OF Dona Ana

ON August 7<sup>th</sup> 2001, before me Bill Vittitow  
personally appeared Bill Vittitow, personally known to me  
(or proved to me on the basis of satisfactory evidence) to be the person(s) whose name(s) is/are subscribed to the within instrument and acknowledged to me that he/she/they executed the same in his/her/there authorized capacity(ies), and that by his/her/their signature(s) on the instrument the person(s) or the entity upon behalf of which the person(s) acted, executed the instrument.

ENTERED INTO COMPUTER

LM 9/13/01

WITNESS my hand and official seal

Signature D. Phine Johnson Date 8-07-01



(this area for notarial seal)

RECORDING REQUESTED BY:

(Mail recording to)

NAME MELVIN E. Shockey  
ADDRESS 649 EAST 16TH ST.  
SAN BERNARDINO, CA. 92404

ONLY change is  
OWNER'S  
Boundaries and  
Name stay the  
same

**Amended Placer Mining Claim Location Notice**

To whom it may concern, please take notice that: The name of this claim is being changed.

The name of this mining claim is WYN YARRA a placer mining claim

The claim is located in the county of LAPAZ State of ARIZONA

The date of location is the 14 day February, 1996 on which date the notice was posted on claim.

The acreage of said claim is 20 acres.

**This claim is situated in**

SUNSHINE GULCH about Sec. 27-26 T. 4N R. 21W Mer 61/2 SALT RIVER

1 MILE IN a WESTERLY Sec. \_\_\_\_\_ T. \_\_\_\_\_ R. \_\_\_\_\_ Mer \_\_\_\_\_

direction FROM Sec. \_\_\_\_\_ T. \_\_\_\_\_ R. \_\_\_\_\_ Mer \_\_\_\_\_

Goodmine Mine Sec. \_\_\_\_\_ T. \_\_\_\_\_ R. \_\_\_\_\_ Mer \_\_\_\_\_

(N. GOODMAN Rd) Sec. \_\_\_\_\_ T. \_\_\_\_\_ R. \_\_\_\_\_ Mer \_\_\_\_\_

Sec. \_\_\_\_\_ T. \_\_\_\_\_ R. \_\_\_\_\_ Mer \_\_\_\_\_

Sec. \_\_\_\_\_ T. \_\_\_\_\_ R. \_\_\_\_\_ Mer \_\_\_\_\_

Sec. \_\_\_\_\_ T. \_\_\_\_\_ R. \_\_\_\_\_ Mer \_\_\_\_\_

Description of discovery monument is as follows STONE MONUMENT

Date of monument erection and marking is \_\_\_\_\_ day of \_\_\_\_\_ 19\_\_\_\_.

Locator(s) of this placer claim is

Name(s)  
MELVIN E Shockey  
SUSAN J. Shockey

Current Mailing Address  
649 East 16th St.  
SAN BERNARDINO, CA.  
92404

RECEIVED  
BUREAU OF  
LAND MANAGEMENT  
2001 AUG 24 A 9:46  
FIELD OFFICE  
SAN BERNARDINO, ARIZONA

I/ We the locators keep all rights of deposits within the lines of this claim, timber, water, and all other rights and privileges granted to locators under the laws of the United States of America.

# MAP, PLAT, OR SKETCH OF MINING CLAIM

MN-1b © LawForms 3-80

Claim Monument lies in Section 26 & 27 Range 21 W Township 4 N G & SR B & M

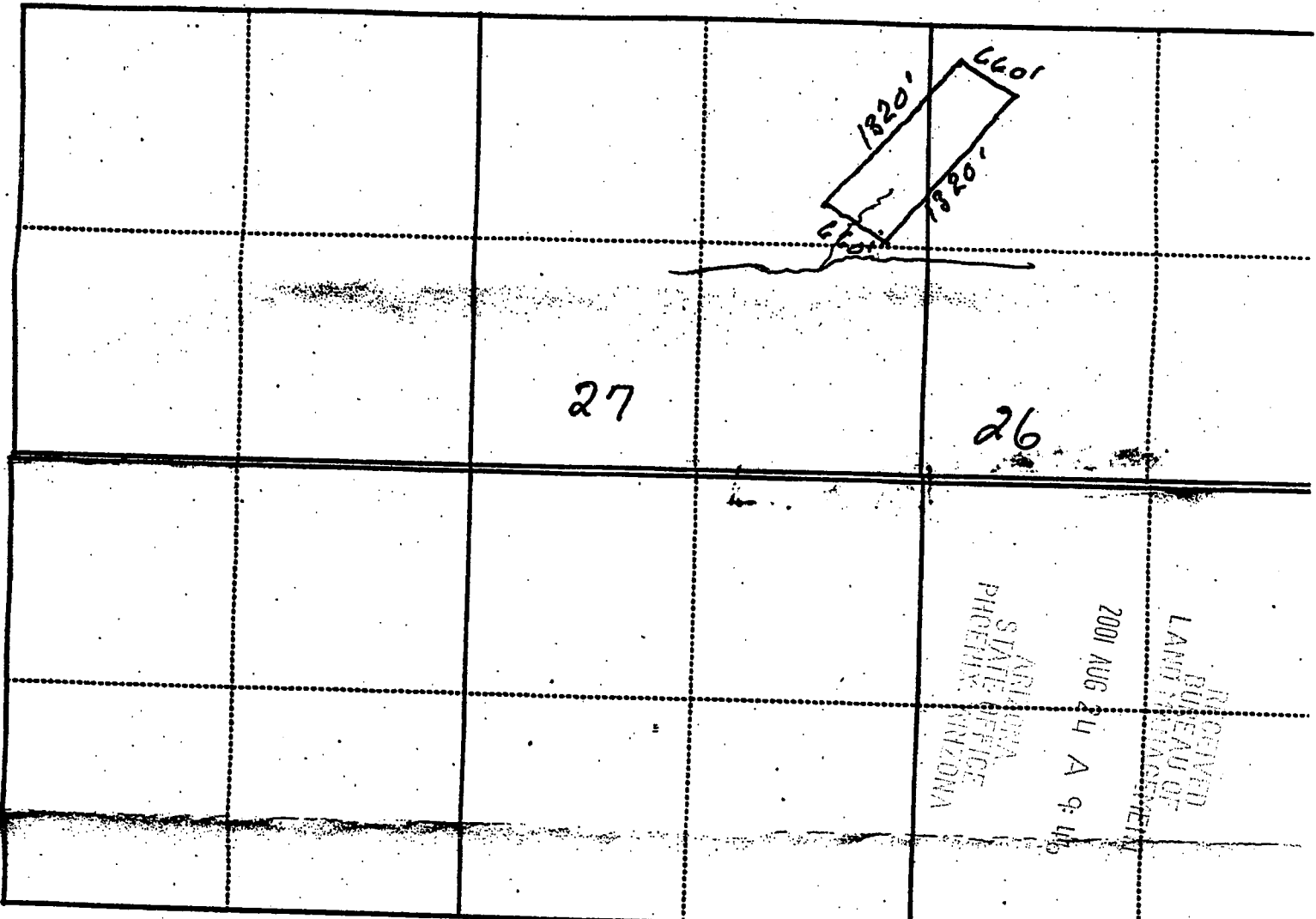

SCALE (Choose One)

1 : 24000 (1 inch = 2000 feet)

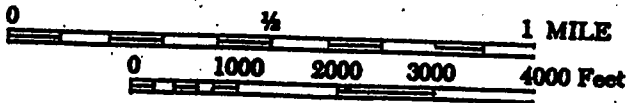

1 : 12000 (1 inch = 1000 feet)

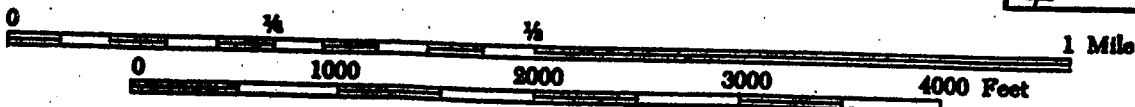

Other (1 inch = not more than 2000 feet)

NORTH ARROW  
(Show Direction)

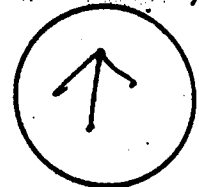

Grid  Magnetic

Please RETURN  
Copies To

M.E. Shockey  
649 E. 16th St.  
San Bernardino, CA 92404

check # 4824 Maintenance fee  
Recording fee & RETURN  
postage \$106.00

Thanks  
Mel Shockey

RECEIVED  
BUREAU OF  
LAND MANAGEMENT

2001 AUG 24 A 9:46

ARIZONA  
STATE OFFICE  
PHOENIX, ARIZONA

ENTERED IN COMPUTER  
RE 9/7/2001



**United States Department of the Interior**  
**Bureau of Land Management**  
 BUSINESS & SUPPORT SVCS DIV  
 222 N CENTRAL AVE  
 PHOENIX, AZ 85004 -2203  
 Phone: (602) 417-9200

Receipt	
No:	365053

**Transaction #:** 383662  
**Date of Transaction:** 08/25/2001

**CUSTOMER:** M E SHOCKEY  
 649 E 16TH ST  
 SAN BERNADINO, CA 92404

LINE #	QTY	COMMODITY / SUBJECT / ACTION / PRODUCT	REMARKS	UNIT PRICE	TOTAL
1	1.00	LOCATABLE MINERALS / MINING CLAIMS-NOT NEW-UNADJUD, ONE AUTH NO. ONLY / MINING CLAIM MONEY RECEIVED (455)	TRF (1)	- n/a -	\$5.00
2	1.00	LOCATABLE MINERALS / MINING CLAIMS-NOT NEW-UNADJUD, ONE AUTH NO. ONLY / MINING CLAIM MONEY RECEIVED (455)	MAINT 2002 (1)	- n/a -	\$100.00
3	6.00	IAC PRODUCTS / COPIES / CASEFILE/DOCUMENT COPIES / COPIES (B/W UP TO 11X17)-\$.13/P		\$0.13	\$0.78
4	1.00	IAC PRODUCTS / SERVICE/ADMIN CHARGES / MAILING COSTS / POSTAGE		- n/a -	\$0.22

**TOTAL:** **\$106.00**

**PAYMENT INFORMATION**

1	<b>AMOUNT:</b>	\$106.00	<b>POSTMARKED:</b>	08/22/2001
	<b>TYPE:</b>	CHECK	<b>RECEIVED:</b>	08/24/2001
	<b>CHECK NO:</b>	4824		
	<b>NAME:</b>	SHOCKEY, MELVIN E 649 E 16TH ST SAN BERNADINO CA 92404		

**REMARKS**

PHONE: 909-885-6095

CASE SERIAL NUMBER INFORMATION		
TRNS #	LINE #	CASES
383662	1	AMC338267/\$5.00
383662	2	AMC338267/\$100.00
383662	3	- n/a -
383662	4	- n/a -

This receipt was generated by the automated BLM Collections and Billings System and is a paper representation of a portion of the official electronic record contained therein.



**MAINTENANCE FEE PAYMENT**

**\$100.00 MAINTENANCE FEE PAYMENT DUE ON OR BEFORE AUGUST 31, 2000  
IN LIEU OF ASSESSMENT WORK FOR THE UPCOMING ASSESSMENT  
YEAR BEGINNING SEPTEMBER 1 OF THE YEAR NOTED ABOVE.**

BUREAU OF LAND MANAGEMENT  
ARIZONA STATE OFFICE  
3707 NORTH 7TH STREET  
PHOENIX, AZ 85014 (OR)  
P.O. BOX 16563, PHOENIX, AZ 85011

COUNT: <u>1</u> \$ <u>100</u> INT: <u>C</u>
FOR OFFICIAL USE ONLY

THE CLAIMS ARE SITUATED IN \_\_\_\_\_ COUNTY, ARIZONA.

BLM SERIAL NUMBERS \_\_\_\_\_ NAMES OF CLAIMS OR SITES \_\_\_\_\_  
 A MC 338267 THRU A MC \_\_\_\_\_ WYN YARRA  
 COUNTY BOOK/DOCKET \_\_\_\_\_, PAGE(S) OR FEE NO(S) 90-00971  
 A MC \_\_\_\_\_ THRU A MC \_\_\_\_\_  
 COUNTY BOOK/DOCKET \_\_\_\_\_, PAGE(S) OR FEE NO(S) \_\_\_\_\_

(OR) IF NOT CONSECUTIVE NUMBERS LIST SEPARATELY BELOW:

BLM SERIAL NUMBERS	NAME OF CLAIMS/SITES	COUNTY BOOK/DOCKET & PAGE OR FEE NUMBER
A MC _____	_____	_____
A MC _____	_____	_____
A MC _____	_____	_____
A MC _____	_____	_____
A MC _____	_____	_____
A MC _____	_____	_____
A MC _____	_____	_____
A MC _____	_____	_____
A MC _____	_____	_____
A MC _____	_____	_____

CLAIMANT'S NAME: BILL / ARINETTA Vittitow

ADDRESS: 2697 BEARCAT DR. CITY: LAS CRUCES STATE: NM

CHECK HERE IF THIS IS A CHANGE OF ADDRESS PHONE: (505) 647-5782 ZIP: 88001

SIGNATURE: Bill R. Vittitow  
TO RECORD WITH THE COUNTY, ONE CLAIMANT OR THE AGENT MUST SIGN

LIST ALL ADDITIONAL OWNERS ON REVERSE SIDE OF THIS FORM

FOR OFFICIAL USE ONLY		
ENTERED INTO COMPUTER: <u>9-13-00</u>	<u>SC</u>	SEP 19 2000
DATE	INITIALS	VERIFIED

TIME STAMP  
 ARIZONA STATE OFFICE  
 PHOENIX, ARIZONA  
 SEP 8 11 41 AM '00  
 RECEIVED  
 BUREAU OF LAND MANAGEMENT

*Timely filed*

43 CFR 3833.0-5(e) (August 30, 1994) REQUIRES THAT THE NAMES OF ALL OF THE OWNERS AND THEIR CURRENT ADDRESSES SHALL BE IDENTIFIED ON ALL INSTRUMENTS REQUIRED TO BE RECORDED OR FILED BY THE REGULATIONS, 43 CFR SUBPART 3833.

CLAIMANT'S NAME: \_\_\_\_\_

ADDRESS: \_\_\_\_\_ CITY: \_\_\_\_\_ STATE: \_\_\_\_\_

CHECK HERE IF THIS IS CHANGE OF ADDRESS      PHONE: (    ) \_\_\_\_\_ ZIP: \_\_\_\_\_

CLAIMANT'S NAME: \_\_\_\_\_

ADDRESS: \_\_\_\_\_ CITY: \_\_\_\_\_ STATE: \_\_\_\_\_

CHECK HERE IF THIS IS CHANGE OF ADDRESS      PHONE: (    ) \_\_\_\_\_ ZIP: \_\_\_\_\_

CLAIMANT'S NAME: \_\_\_\_\_

ADDRESS: \_\_\_\_\_ CITY: \_\_\_\_\_ STATE: \_\_\_\_\_

CHECK HERE IF THIS IS CHANGE OF ADDRESS      PHONE: (    ) \_\_\_\_\_ ZIP: \_\_\_\_\_

CLAIMANT'S NAME: \_\_\_\_\_

ADDRESS: \_\_\_\_\_ CITY: \_\_\_\_\_ STATE: \_\_\_\_\_

CHECK HERE IF THIS IS CHANGE OF ADDRESS      PHONE: (    ) \_\_\_\_\_ ZIP: \_\_\_\_\_

CLAIMANT'S NAME: \_\_\_\_\_

ADDRESS: \_\_\_\_\_ CITY: \_\_\_\_\_ STATE: \_\_\_\_\_

CHECK HERE IF THIS IS CHANGE OF ADDRESS      PHONE: (    ) \_\_\_\_\_ ZIP: \_\_\_\_\_

CLAIMANT'S NAME: \_\_\_\_\_

ADDRESS: \_\_\_\_\_ CITY: \_\_\_\_\_ STATE: \_\_\_\_\_

CHECK HERE IF THIS IS CHANGE OF ADDRESS      PHONE: (    ) \_\_\_\_\_ ZIP: \_\_\_\_\_

CLAIMANT'S NAME: \_\_\_\_\_

ADDRESS: \_\_\_\_\_ CITY: \_\_\_\_\_ STATE: \_\_\_\_\_

CHECK HERE IF THIS IS CHANGE OF ADDRESS      PHONE: (    ) \_\_\_\_\_ ZIP: \_\_\_\_\_

SEPT 5, 2000

BLM

DEAR SIR,

RECENTLY MOVED OUT OF STATE AND  
INAVERTANTLY USED OLD ADDRESS MAKING OUR  
LEASE FEE

AS YOU CAN SEE, MAILED BEFORE DEADLINE  
POSTMARKED AUG. 26 AND ENVELOPE HAS  
NOT BEEN OPENED. AM ENCLOSED STAMP &  
UNTOUCHED TO SHOW WAS IN GOOD FAITH.

YOUR ACCEPTANCE WOULD BE GREATLY  
APPRECIATED.

THANK YOU  
Bill R. Whitton

2697 BEARCAT DR.  
LAS CRUCES, NM 88001  
(505) 647-5782

ARIZONA  
STATE OFFICE  
PHOENIX, ARIZONA

SEP 8 11 42 AM '00

RECEIVED  
BUREAU OF  
LAND MANAGEMENT

ARIZONA  
STATE OFFICE  
PHOENIX, ARIZONA

SEP 8 11 42 AM '00

RECEIVED  
BUREAU OF  
LAND MANAGEMENT

<http://www.bajaquest.com/bottomfrm.htm>

09/02/2000

**United States Department of the Interior  
Bureau of Land Management**  
BUSINESS & SUPPORT SVCS DIV  
222 N CENTRAL AVE  
PHOENIX, AZ 85004 -2203  
Phone: (602) 417-9200

Receipt	
No:	187141

**Transaction #:** 200581  
**Date of Transaction:** 09/11/2000

**CUSTOMER:** BILL VITTITOW  
2697 BEARCAT DR  
LAS CRUCES, NM 88001

LINE #	QTY	COMMODITY / SUBJECT / ACTION / PRODUCT	REMARKS	UNIT PRICE	TOTAL
1	1	LOCATABLE MINERALS / MINING CLAIMS-ACCOUNTS/UNADJUDICATED / MINING CLAIM MONEY RECEIVED (455)	MAINT 2001 (1)	- n/a -	\$100.00
<b>TOTAL:</b>					<b>\$100.00</b>

PAYMENT INFORMATION		
1	AMOUNT: \$100.00	POSTMARKED: 09/05/2000
	TYPE: CHECK	RECEIVED: 09/08/2000
	CHECK NO: 1314	
	NAME: VITTITOW, BILL R 2697 BEARCAT DR LAS CRUCES NM 88001	

REMARKS

CASE SERIAL NUMBER INFORMATION		
TRNS #	LINE #	CASES
200581	1	AMC338267

This receipt was generated by the automated BLM Collections and Billings System and is a paper representation of a portion of the official electronic record contained therein.





43 CFR 3833.0-5(e) (August 30, 1994) REQUIRES THAT THE NAMES OF ALL OF THE OWNERS AND THEIR CURRENT ADDRESSES SHALL BE IDENTIFIED ON ALL INSTRUMENTS REQUIRED TO BE RECORDED OR FILED BY THE REGULATIONS, 43 CFR SUBPART 3833.

CLAIMANT'S NAME: \_\_\_\_\_  
ADDRESS: \_\_\_\_\_ CITY: \_\_\_\_\_ STATE: \_\_\_\_\_ ZIP: \_\_\_\_\_  
 CHECK HERE IF THIS PHONE: ( ) \_\_\_\_\_  
IS A CHANGE OF ADDRESS

CLAIMANT'S NAME: \_\_\_\_\_  
ADDRESS: \_\_\_\_\_ CITY: \_\_\_\_\_ STATE: \_\_\_\_\_ ZIP: \_\_\_\_\_  
 CHECK HERE IF THIS PHONE: ( ) \_\_\_\_\_  
IS A CHANGE OF ADDRESS

CLAIMANT'S NAME: \_\_\_\_\_  
ADDRESS: \_\_\_\_\_ CITY: \_\_\_\_\_ STATE: \_\_\_\_\_ ZIP: \_\_\_\_\_  
 CHECK HERE IF THIS PHONE: ( ) \_\_\_\_\_  
IS A CHANGE OF ADDRESS

CLAIMANT'S NAME: \_\_\_\_\_  
ADDRESS: \_\_\_\_\_ CITY: \_\_\_\_\_ STATE: \_\_\_\_\_ ZIP: \_\_\_\_\_  
 CHECK HERE IF THIS PHONE: ( ) \_\_\_\_\_  
IS A CHANGE OF ADDRESS

CLAIMANT'S NAME: \_\_\_\_\_  
ADDRESS: \_\_\_\_\_ CITY: \_\_\_\_\_ STATE: \_\_\_\_\_ ZIP: \_\_\_\_\_  
 CHECK HERE IF THIS PHONE: ( ) \_\_\_\_\_  
IS A CHANGE OF ADDRESS

CLAIMANT'S NAME: \_\_\_\_\_  
ADDRESS: \_\_\_\_\_ CITY: \_\_\_\_\_ STATE: \_\_\_\_\_ ZIP: \_\_\_\_\_  
 CHECK HERE IF THIS PHONE: ( ) \_\_\_\_\_  
IS A CHANGE OF ADDRESS

CLAIMANT'S NAME: \_\_\_\_\_  
ADDRESS: \_\_\_\_\_ CITY: \_\_\_\_\_ STATE: \_\_\_\_\_ ZIP: \_\_\_\_\_  
 CHECK HERE IF THIS PHONE: ( ) \_\_\_\_\_  
IS A CHANGE OF ADDRESS

CLAIMANT'S NAME: \_\_\_\_\_  
ADDRESS: \_\_\_\_\_ CITY: \_\_\_\_\_ STATE: \_\_\_\_\_ ZIP: \_\_\_\_\_  
 CHECK HERE IF THIS PHONE: ( ) \_\_\_\_\_  
IS A CHANGE OF ADDRESS

UNITED STATES  
DEPARTMENT OF THE INTERIOR  
BUREAU OF LAND MANAGEMENT

RECEIPT AND ACCOUNTING ADVICE

NO. 2296783 07

CD/AZ

08/24/99

Subject: CLAIM MAINTENANCE FEE 2000

2 6 13

100.00

Applicant:

BILL & ARNETTA VITTITOW  
PO BOX 2644  
QUARTZSITE AZ 85346

CK 1113

Remitter: 520-97-5235

Assignor:

LEASE MANAGEMENT DATA  NEW  UPDATE  PAYMENT

ORIGINAL SERIAL NO.	ASG.	TYPE	ST.	CTY.	FUND SYMBOL	ACRES/UNITS	RATE
AMC 338267							

AMOUNT	ANV. DATE	EXP. DATE	BILL CYC.	S/C	DISTRICT	NEXT BILL	MISC. DATA	U of M	ACTUAL UNITS

ASSIGNMENT SERIAL NO.	ASG.	TYPE	ST.	CTY.	FUND SYMBOL	ACRES/UNITS	RATE

AMOUNT	ANV. DATE	EXP. DATE	BILL CYC.	S/C	DISTRICT	NEXT BILL	MISC. DATA	U of M	ACTUAL UNITS

APPLY REMITTANCE			
ACTION	FUND SYMBOL	CTY.	AMOUNT
FILING FEE			
RENTAL			
UNEARNED			
REFUND			
TOTAL			
AMOUNT DUE			

Remarks:

BY: \_\_\_\_\_ DATE: \_\_\_\_\_

Lease in Escrow?  
 KGS? Of Interest?  
 Auto Escalates? Operating Rights?  
 Auto Renew? Operator  
 Bond Filed?

**FOR MMS USE ONLY**

BILLEE	FOREST REFUGE
NUMBER	
OCS SECTION	
CODE	

## MAINTENANCE FEE PAYMENT

\$100.00 MAINTENANCE FEE PAYMENT DUE ON OR BEFORE AUGUST 31, 19 98  
 IN LIEU OF ASSESSMENT WORK FOR THE UPCOMING ASSESSMENT  
 YEAR BEGINNING SEPTEMBER 1 OF THE YEAR NOTED ABOVE.

BUREAU OF LAND MANAGEMENT  
 ARIZONA STATE OFFICE  
 222 NORTH CENTRAL AVENUE  
 PHOENIX, AZ 85004

338267-

COUNT: 1 \$ 100.00 INT: 5% FOR  
**OFFICIAL USE ONLY**

THE CLAIMS ARE SITUATED IN LA PAZ COUNTY, ARIZONA.

BLM SERIAL NUMBERS	NAMES OF CLAIMS OR SITES
A MC <u>338267</u> THRU A MC <u>—</u> COUNTY BOOK/DOCKET _____, PAGE(S) OR FEE NO(S) _____	<u>WYN YARRA</u> <u>96-00971</u>
A MC _____ THRU A MC _____ COUNTY BOOK/DOCKET _____, PAGE(S) OR FEE NO(S) _____	

(OR) IF NOT CONSECUTIVE NUMBERS LIST SEPARATELY BELOW:

BLM SERIAL NUMBERS	NAME OF CLAIMS/SITES	COUNTY BOOK/DOCKET & PAGE OR FEE NUMBER
A MC _____	_____	_____
A MC _____	_____	_____
A MC _____	_____	_____
A MC _____	_____	_____
A MC _____	_____	_____
A MC _____	_____	_____
A MC _____	_____	_____
A MC _____	_____	_____
A MC _____	_____	_____
A MC _____	_____	_____
A MC _____	_____	_____
A MC _____	_____	_____

CLAIMANT'S NAME: BILL / ARNETTA V. HITOW

ADDRESS: P.O. BOX 2644 CITY: QUARTZSITE STATE: AZ ZIP: 85346

CHECK HERE IF THIS PHONE: ( )  
 IS A CHANGE OF ADDRESS

SIGNATURE: Bill R. Vittetow  
 TO RECORD WITH THE COUNTY, ONE CLAIMANT OR THE AGENT MUST SIGN

LIST ALL ADDITIONAL OWNERS ON REVERSE SIDE OF THIS FORM

**FOR OFFICIAL USE ONLY**

ENTERED INTO COMPUTER: AUG 28 SB XK  
 DATE INITIALS VERIFIED

TIME STAMP

AUG 26 9 57 AM '98

ARIZONA  
 STATE OFFICE  
 PHOENIX, ARIZONA

RECEIVED  
 BUREAU OF  
 LAND MANAGEMENT

**43 CFR 3833.0-5(e) (August 30, 1994) REQUIRES THAT THE NAMES OF ALL OF THE OWNERS AND THEIR CURRENT ADDRESSES SHALL BE IDENTIFIED ON ALL INSTRUMENTS REQUIRED TO BE RECORDED OR FILED BY THE REGULATIONS, 43 CFR SUBPART 3833.**

CLAIMANT'S NAME: \_\_\_\_\_  
ADDRESS: \_\_\_\_\_ CITY: \_\_\_\_\_ STATE: \_\_\_\_\_ ZIP: \_\_\_\_\_  
 CHECK HERE IF THIS PHONE: ( ) \_\_\_\_\_  
IS A CHANGE OF ADDRESS

CLAIMANT'S NAME: \_\_\_\_\_  
ADDRESS: \_\_\_\_\_ CITY: \_\_\_\_\_ STATE: \_\_\_\_\_ ZIP: \_\_\_\_\_  
 CHECK HERE IF THIS PHONE: ( ) \_\_\_\_\_  
IS A CHANGE OF ADDRESS

CLAIMANT'S NAME: \_\_\_\_\_  
ADDRESS: \_\_\_\_\_ CITY: \_\_\_\_\_ STATE: \_\_\_\_\_ ZIP: \_\_\_\_\_  
 CHECK HERE IF THIS PHONE: ( ) \_\_\_\_\_  
IS A CHANGE OF ADDRESS

CLAIMANT'S NAME: \_\_\_\_\_  
ADDRESS: \_\_\_\_\_ CITY: \_\_\_\_\_ STATE: \_\_\_\_\_ ZIP: \_\_\_\_\_  
 CHECK HERE IF THIS PHONE: ( ) \_\_\_\_\_  
IS A CHANGE OF ADDRESS

CLAIMANT'S NAME: \_\_\_\_\_  
ADDRESS: \_\_\_\_\_ CITY: \_\_\_\_\_ STATE: \_\_\_\_\_ ZIP: \_\_\_\_\_  
 CHECK HERE IF THIS PHONE: ( ) \_\_\_\_\_  
IS A CHANGE OF ADDRESS

CLAIMANT'S NAME: \_\_\_\_\_  
ADDRESS: \_\_\_\_\_ CITY: \_\_\_\_\_ STATE: \_\_\_\_\_ ZIP: \_\_\_\_\_  
 CHECK HERE IF THIS PHONE: ( ) \_\_\_\_\_  
IS A CHANGE OF ADDRESS

CLAIMANT'S NAME: \_\_\_\_\_  
ADDRESS: \_\_\_\_\_ CITY: \_\_\_\_\_ STATE: \_\_\_\_\_ ZIP: \_\_\_\_\_  
 CHECK HERE IF THIS PHONE: ( ) \_\_\_\_\_  
IS A CHANGE OF ADDRESS

CLAIMANT'S NAME: \_\_\_\_\_  
ADDRESS: \_\_\_\_\_ CITY: \_\_\_\_\_ STATE: \_\_\_\_\_ ZIP: \_\_\_\_\_  
 CHECK HERE IF THIS PHONE: ( ) \_\_\_\_\_  
IS A CHANGE OF ADDRESS

UNITED STATES  
DEPARTMENT OF THE INTERIOR  
BUREAU OF LAND MANAGEMENT

RECEIPT AND ACCOUNTING ADVICE

NO. 2389712 <sup>04</sup>  
ST/AZ 08/27/98

Subject: CLAIM MAINTENANCE FEE 1999 (1) 2 23 13 100.00 ✓

Applicant:  
BILL VITTITOW  
P O BOX 2644  
QUARTZSITE, AZ 85346

CH # 971  
Remitter: 520 927-5235

Assignor:

LEASE MANAGEMENT DATA  NEW  UPDATE  PAYMENT

ORIGINAL SERIAL NO.	ASG.	TYPE	ST.	CTY.	FUND SYMBOL	ACRES/UNITS	RATE
AMC338267							

AMOUNT	ANV. DATE	EXP. DATE	BILL CYC.	S/C	DISTRICT	NEXT BILL	MISC. DATA	U of M	ACTUAL UNITS

ASSIGNMENT SERIAL NO.	ASG.	TYPE	ST.	CTY.	FUND SYMBOL	ACRES/UNITS	RATE

AMOUNT	ANV. DATE	EXP. DATE	BILL CYC.	S/C	DISTRICT	NEXT BILL	MISC. DATA	U of M	ACTUAL UNITS

APPLY REMITTANCE				Remarks:
ACTION	FUND SYMBOL	CTY.	AMOUNT	
FILING FEE				
RENTAL				
UNEARNED				
REFUND				
TOTAL				
AMOUNT DUE				

BY: \_\_\_\_\_ DATE: \_\_\_\_\_

Lease in Escrow?  
 KGS?  
 Auto Escalates?  
 Auto Renew?

Of Interest?  
 Operating Rights?  
 Operator  
 Bond Filed?

FOR MMS USE ONLY		
BILLEE		FOREST REFUGE
NUMBER		
OCS SECTION		
CODE		

A-MC  
338267  
RD

### MAINTENANCE FEE PAYMENT

\$100.00 MAINTENANCE FEE PAYMENT DUE ON OR BEFORE AUGUST 31, 19 97  
IN LIEU OF ASSESSMENT WORK FOR THE UPCOMING ASSESSMENT  
YEAR BEGINNING SEPTEMBER 1 OF THE YEAR NOTED ABOVE.

BUREAU OF LAND MANAGEMENT  
ARIZONA STATE OFFICE  
222 NORTH CENTRAL AVENUE  
PHOENIX, AZ 85004

COUNT: 1 \$ 100.00 INT. MS FOR  
OFFICIAL USE ONLY

THE CLAIMS ARE SITUATED IN LAPAZ COUNTY, ARIZONA.

BLM SERIAL NUMBERS NAMES OF CLAIMS OR SITES  
A MC 338267 THRU A MC --- WYNYARRA  
COUNTY BOOK/DOCKET \_\_\_\_\_, PAGE(S) OR FEE NO(S) 96-00971  
A MC \_\_\_\_\_ THRU A MC \_\_\_\_\_  
COUNTY BOOK/DOCKET \_\_\_\_\_, PAGE(S) OR FEE NO(S) \_\_\_\_\_

(OR) IF NOT CONSECUTIVE NUMBERS LIST SEPARATELY BELOW:

BLM SERIAL NUMBERS	NAME OF CLAIMS/SITES	COUNTY BOOK/DOCKET & PAGE OR FEE NUMBER
A MC _____	_____	_____
A MC _____	_____	_____
A MC _____	_____	_____
A MC _____	_____	_____
A MC _____	_____	_____
A MC _____	_____	_____
A MC _____	_____	_____
A MC _____	_____	_____
A MC _____	_____	_____
A MC _____	_____	_____
A MC _____	_____	_____
A MC _____	_____	_____
A MC _____	_____	_____
A MC _____	_____	_____

CLAIMANT'S NAME: BILL / ARNETTA VITTITOW  
ADDRESS: P.O. Box 2644 CITY: QUARTZSITE STATE: AZ ZIP: 85346  
 CHECK HERE IF THIS IS A CHANGE OF ADDRESS PHONE: (602) 927-5835

SIGNATURE: Bill R. Vittitow  
TO RECORD WITH THE COUNTY, ONE CLAIMANT OR THE AGENT MUST SIGN

RECEIVED  
BUREAU OF  
LAND MANAGEMENT  
AUG 14 10 06 AM '97  
ARIZONA  
STATE OFFICE  
PHOENIX, ARIZONA

LIST ALL ADDITIONAL OWNERS ON REVERSE SIDE OF THIS FORM  
FOR OFFICIAL USE ONLY  
ENTERED IN COMPUTER  
ENTERED INTO COMPUTER: 9/10/97 PB Q  
DATE INITIALS VERIFIED

43 CFR 3833.0-5(e) (August 30, 1994) REQUIRES THAT THE NAMES OF ALL OF THE OWNERS AND THEIR CURRENT ADDRESSES SHALL BE IDENTIFIED ON ALL INSTRUMENTS REQUIRED TO BE RECORDED OR FILED BY THE REGULATIONS, 43 CFR SUBPART 3833.

CLAIMANT'S NAME: \_\_\_\_\_  
ADDRESS: \_\_\_\_\_ CITY: \_\_\_\_\_ STATE: \_\_\_\_\_ ZIP: \_\_\_\_\_  
 CHECK HERE IF THIS PHONE: ( ) \_\_\_\_\_  
IS A CHANGE OF ADDRESS

CLAIMANT'S NAME: \_\_\_\_\_  
ADDRESS: \_\_\_\_\_ CITY: \_\_\_\_\_ STATE: \_\_\_\_\_ ZIP: \_\_\_\_\_  
 CHECK HERE IF THIS PHONE: ( ) \_\_\_\_\_  
IS A CHANGE OF ADDRESS

CLAIMANT'S NAME: \_\_\_\_\_  
ADDRESS: \_\_\_\_\_ CITY: \_\_\_\_\_ STATE: \_\_\_\_\_ ZIP: \_\_\_\_\_  
 CHECK HERE IF THIS PHONE: ( ) \_\_\_\_\_  
IS A CHANGE OF ADDRESS

CLAIMANT'S NAME: \_\_\_\_\_  
ADDRESS: \_\_\_\_\_ CITY: \_\_\_\_\_ STATE: \_\_\_\_\_ ZIP: \_\_\_\_\_  
 CHECK HERE IF THIS PHONE: ( ) \_\_\_\_\_  
IS A CHANGE OF ADDRESS

CLAIMANT'S NAME: \_\_\_\_\_  
ADDRESS: \_\_\_\_\_ CITY: \_\_\_\_\_ STATE: \_\_\_\_\_ ZIP: \_\_\_\_\_  
 CHECK HERE IF THIS PHONE: ( ) \_\_\_\_\_  
IS A CHANGE OF ADDRESS

CLAIMANT'S NAME: \_\_\_\_\_  
ADDRESS: \_\_\_\_\_ CITY: \_\_\_\_\_ STATE: \_\_\_\_\_ ZIP: \_\_\_\_\_  
 CHECK HERE IF THIS PHONE: ( ) \_\_\_\_\_  
IS A CHANGE OF ADDRESS

CLAIMANT'S NAME: \_\_\_\_\_  
ADDRESS: \_\_\_\_\_ CITY: \_\_\_\_\_ STATE: \_\_\_\_\_ ZIP: \_\_\_\_\_  
 CHECK HERE IF THIS PHONE: ( ) \_\_\_\_\_  
IS A CHANGE OF ADDRESS

CLAIMANT'S NAME: \_\_\_\_\_  
ADDRESS: \_\_\_\_\_ CITY: \_\_\_\_\_ STATE: \_\_\_\_\_ ZIP: \_\_\_\_\_  
 CHECK HERE IF THIS PHONE: ( ) \_\_\_\_\_  
IS A CHANGE OF ADDRESS



UNITED STATES  
DEPARTMENT OF THE INTERIOR  
BUREAU OF LAND MANAGEMENT

RECEIPT AND ACCOUNTING ADVICE

NO. 2315305 04

TC/AZ

08/14/97

Subject: CLAIM MAINTENANCE FEE 1998

2 12 13

100.00

Applicant:  
BILL & ARNETTA VITTITOW  
BOX 2644  
QUARTZSITE AZ 85346

Remitter: CK 585  
520-927-5235

Assignor:

LEASE MANAGEMENT DATA									
<input type="checkbox"/> NEW <input type="checkbox"/> UPDATE <input type="checkbox"/> PAYMENT									
ORIGINAL SERIAL NO.	ASG.	TYPE	ST.	CTY.	FUND SYMBOL			ACRES/UNITS	RATE
AMC 338267									
AMOUNT	ANV. DATE	EXP. DATE	BILL CYC.	S/C	DISTRICT	NEXT BILL	MISC. DATA	U of M	ACTUAL UNITS
ASSIGNMENT SERIAL NO.	ASG.	TYPE	ST.	CTY.	FUND SYMBOL			ACRES/UNITS	RATE
AMOUNT	ANV. DATE	EXP. DATE	BILL CYC.	S/C	DISTRICT	NEXT BILL	MISC. DATA	U of M	ACTUAL UNITS

APPLY REMITTANCE				Remarks:
ACTION	FUND SYMBOL	CTY.	AMOUNT	
FILING FEE				
RENTAL				
UNEARNED				
REFUND				
TOTAL				
AMOUNT DUE				

BY:

DATE:

- Lease in Escrow?
- KGS?                      Of Interest?
- Auto Escalates?            Operating Rights?
- Auto Renew?                Operator
- Bond Filed?

**FOR MMS USE ONLY**

BILLEE		FOREST REFUGE
NUMBER		
OCS SECTION		
CODE		



43 CFR 3833.0-5(e) (August 30, 1994) REQUIRES THAT THE NAMES OF ALL OF THE OWNERS AND THEIR CURRENT ADDRESSES SHALL BE IDENTIFIED ON ALL INSTRUMENTS REQUIRED TO BE RECORDED OR FILED BY THE REGULATIONS, 43 CFR SUBPART 3833.

CLAIMANT'S NAME: \_\_\_\_\_

ADDRESS: \_\_\_\_\_ CITY: \_\_\_\_\_ STATE: \_\_\_\_\_

CHECK HERE IF THIS IS CHANGE OF ADDRESS PHONE: ( \_\_\_\_\_ ) ZIP: \_\_\_\_\_

CLAIMANT'S NAME: \_\_\_\_\_

ADDRESS: \_\_\_\_\_ CITY: \_\_\_\_\_ STATE: \_\_\_\_\_

CHECK HERE IF THIS IS CHANGE OF ADDRESS PHONE: ( \_\_\_\_\_ ) ZIP: \_\_\_\_\_

CLAIMANT'S NAME: \_\_\_\_\_

ADDRESS: \_\_\_\_\_ CITY: \_\_\_\_\_ STATE: \_\_\_\_\_

CHECK HERE IF THIS IS CHANGE OF ADDRESS PHONE: ( \_\_\_\_\_ ) ZIP: \_\_\_\_\_

CLAIMANT'S NAME: \_\_\_\_\_

ADDRESS: \_\_\_\_\_ CITY: \_\_\_\_\_ STATE: \_\_\_\_\_

CHECK HERE IF THIS IS CHANGE OF ADDRESS PHONE: ( \_\_\_\_\_ ) ZIP: \_\_\_\_\_

CLAIMANT'S NAME: \_\_\_\_\_

ADDRESS: \_\_\_\_\_ CITY: \_\_\_\_\_ STATE: \_\_\_\_\_

CHECK HERE IF THIS IS CHANGE OF ADDRESS PHONE: ( \_\_\_\_\_ ) ZIP: \_\_\_\_\_

CLAIMANT'S NAME: \_\_\_\_\_

ADDRESS: \_\_\_\_\_ CITY: \_\_\_\_\_ STATE: \_\_\_\_\_

CHECK HERE IF THIS IS CHANGE OF ADDRESS PHONE: ( \_\_\_\_\_ ) ZIP: \_\_\_\_\_

CLAIMANT'S NAME: \_\_\_\_\_

ADDRESS: \_\_\_\_\_ CITY: \_\_\_\_\_ STATE: \_\_\_\_\_

CHECK HERE IF THIS IS CHANGE OF ADDRESS PHONE: ( \_\_\_\_\_ ) ZIP: \_\_\_\_\_

UNITED STATES  
DEPARTMENT OF THE INTERIOR  
BUREAU OF LAND MANAGEMENT

RECEIPT AND ACCOUNTING ADVICE

NO. **2263362**

TC/AZ

08/23/96

24

Subject: CLAIM MAINTENANCE FEE 1997 - 1

2 32 13

100.00

Applicant:

BILL OR ARNETTA VITTITOVV  
BOX 2644  
QUARTZSITE AZ 85346

SAME AS CK 3735

Remitter: 520-927-5235

Assignor:

LEASE MANAGEMENT DATA										<input type="checkbox"/> NEW	<input type="checkbox"/> UPDATE	<input type="checkbox"/> PAYMENT
ORIGINAL SERIAL NO.		ASG.	TYPE	ST.	CTY.	FUND SYMBOL			ACRES/UNITS	RATE		
AMC 338267												
AMOUNT	ANV. DATE	EXP. DATE	BILL CYC.	S/C	DISTRICT	NEXT BILL	MISC. DATA	U of M	ACTUAL UNITS			
ASSIGNMENT SERIAL NO.		ASG.	TYPE	ST.	CTY.	FUND SYMBOL			ACRES/UNITS	RATE		
AMOUNT	ANV. DATE	EXP. DATE	BILL CYC.	S/C	DISTRICT	NEXT BILL	MISC. DATA	U of M	ACTUAL UNITS			
APPLY REMITTANCE					Remarks: <div style="font-size: 2em; font-family: cursive;">AMC 338267</div> <div style="font-size: 1.5em; font-family: cursive;">3r</div>							
ACTION	FUND SYMBOL	CTY.	AMOUNT									
FILING FEE												
RENTAL												
UNEARNED												
REFUND												
TOTAL												
AMOUNT DUE												
<input type="checkbox"/> Lease in Escrow? <input type="checkbox"/> KGS? <input type="checkbox"/> Auto Escalates? <input type="checkbox"/> Auto Renew?					Of Interest? Operating Rights? Operator Bond Filed?							
					<b>FOR MMS USE ONLY</b>							
					BILLEE NUMBER		FOREST REFUGE					
					OCS SECTION CODE							

UNITED STATES  
DEPARTMENT OF THE INTERIOR  
BUREAU OF LAND MANAGEMENT

RECEIPT AND ACCOUNTING ADVICE

NO. 22633b2 <sup>04</sup>

TC/AZ

08/23/96

Subject: CLAIM MAINTENANCE FEE 1997 - 1

2 32 13

100.00

Applicant:

BILL OR ARNETTA VITTITOVV  
BOX 2644  
QUARTZSITE AZ 85346

SAME AS CK 3735

Remitter: 520-927-5235

Assignor:

*AMC 338267 SE*

LEASE MANAGEMENT DATA										<input type="checkbox"/> NEW	<input type="checkbox"/> UPDATE	<input type="checkbox"/> PAYMENT
ORIGINAL SERIAL NO.	ASG.	TYPE	ST.	CTY.	FUND SYMBOL			ACRES/UNITS	RATE			
AMC 338267												
AMOUNT	ANV. DATE	EXP. DATE	BILL CYC.	S/C	DISTRICT	NEXT BILL	MISC. DATA	U of M	ACTUAL UNITS			
ASSIGNMENT SERIAL NO.	ASG.	TYPE	ST.	CTY.	FUND SYMBOL			ACRES/UNITS	RATE			
AMOUNT	ANV. DATE	EXP. DATE	BILL CYC.	S/C	DISTRICT	NEXT BILL	MISC. DATA	U of M	ACTUAL UNITS			

APPLY REMITTANCE			
ACTION	FUND SYMBOL	CTY.	AMOUNT
FILING FEE			
RENTAL			
UNEARNED			
REFUND			
TOTAL			
AMOUNT DUE			

Remarks:

*SE*

BY: \_\_\_\_\_ DATE: \_\_\_\_\_

- Lease in Escrow?
- KGS?                      Of Interest?
- Auto Escalates?            Operating Rights?
- Auto Renew?                Operator
- Bond Filed?

FOR MMS USE ONLY		
BILLEE	NUMBER	FOREST REFUGE
OCS SECTION		
CODE		

**NOTICE!!**

**These documents have been scanned!**

**Do not place un-scanned documents beneath this notice!**

**Do not remove this notice from this file!**

GPO Jacket No. 560-102  
Print Order 61540  
Rise Business Services, LLC  
Job=AZ15 7/15/2019



Box Number= AZ15163



Claim Begin-End: AMC338267-AMC338267

**5 Miscellaneous**

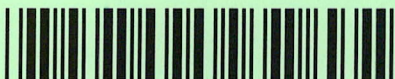

AZ15163-9

AMC337218-AMC338324

OFFICIAL COPIES /CF/ /SD READ/ /GROUP/ /SECTION/ /AUTHOR/

*Handwritten:*  
7-3

3800 (933) SR  
A MC 338267

*Handwritten:* 7/3/96 *Sevins*

JUL 03 1996

Mr. Bill Vittitow  
P.O. Box 2644  
Quartzsite, Arizona 85346

Dear Mr. Vittitow:

The enclosed list identifies the serial numbers that have been assigned to each of your mining claim location notices received by this office on February 15, 1996.

The regulations require you to identify the claim name and A MC serial number of each claim, and the claimant's name and address on all future documents and correspondence filed with the Bureau of Land Management (BLM).

The acknowledgment does not verify that your claims have been located on lands open to mineral entry or are encumbered by rights of other mining claimants. Only those mining claims that are entirely located on private or Federal lands that are not open to mineral entry will be officially declared void by a BLM Decision.

Please advise this office of all changes of address, authorized agents, and transfers of ownership.

Transfers of ownership are governed by 43 CFR 3833.3(a) which states that, "Whenever the owner of an unpatented mining claim, mill site or tunnel site, which has been recorded in accordance with 43 CFR 3833.1, sells, assigns, or otherwise conveys all or any part of his interest in the claim, his transferee shall file in the proper BLM office within 60 days after the completion of the transfer..." A service charge of \$5 per claim is required for all transfers.

**PLEASE NOTE:** Unless you have already paid in advance or will otherwise qualify to be waived from payment, the next annual maintenance fee payment of \$100 for each claim or site, in lieu of assessment, is due on or before August 31, 1996.

By keeping our records current, we will be able to provide better public service. **All future correspondence from this office will be sent only to the above name and address unless otherwise instructed.**

If any of the information listed on the enclosure is not correct, please notify this office in writing.

Sincerely,

/s/ Evelyn Stob



Mary Jo Yoas  
Chief, Lands and Minerals Adjudication

Enclosure

This serves as notification to the following:

Arnetta Vittitow

SRIVAS:ers:7/3/96:Vittitow



CLAIM INDEX

SERIAL NUMBER

A MC 338267

CLAIM NAME

WYNYARRA

CLAIMANT'S NAME

BILL VITTITOW  
ARNETTA VITTITOW

**NOTICE!!**

**These documents have been scanned!**

**Do not place un-scanned documents beneath this notice!**

**Do not remove this notice from this file!**

GPO Jacket No. 560-102  
Print Order 61540  
Rise Business Services, LLC  
Job=AZ15 7/15/2019



Box Number= AZ15163



Claim Begin-End: AMC338267-AMC338267

**6 Location Notices-Amendments and Supporting Documents**



AZ15163-9

AMC337218-AMC338324

K.C. approved  
claim on 2-15-96

OK  
3/26/96 dm

MINING CLAIM STATUS REPORT

Lead Serial No. A MC 338267 THROUGH A MC \_\_\_\_\_

No. of Lode Claims \_\_\_\_\_

STATUS CHECKED BY KC Nash  
Enter Action Code 669

No. of Placer Claims 1

No. of Association Placer \_\_\_\_\_  
(Not Enough Locators Send Form Ltr.)

MTP CHECKED yes  
(Reduced Size Copy Enclosed)

No. of Mill Sites \_\_\_\_\_

ORCA GEO CHECKED yes  
(Copy Enclosed)

No. of Tunnel Sites \_\_\_\_\_

Timely Filed YES NO

WILDERNESS (WA) AREA CHECKED yes

Service Charge Correct YES NO  
(This is Curable)

WHICH WA N/A

Location Fee Correct YES NO

Maintenance Fee Correct YES NO

Amount Paid \$ 135.00

Shortage \$ 0 Overage \$ 0

Over-the-Counter yes Mail \_\_\_\_\_

Township(s) 4N

Range(s) 21W

Section(s) 26 & 27

GENERAL JURISDICTION OF: BLM  (or) WHICH NATIONAL FOREST \_\_\_\_\_

Enter Code 880 On Split Estate Land (Show Type of Patent - SX, PX, SRHE etc)  
N/A

Enter Code 267 For Stockraising Homestead When Proper Notice Has Been Filed  
N/A

STATUS

CLAIMS PARTIALLY VOID: Private Minerals \_\_\_\_\_ Withdrawn \_\_\_\_\_ Other \_\_\_\_\_

N/A

CLAIMS VOID: Private Minerals \_\_\_\_\_ Withdrawn \_\_\_\_\_ Other \_\_\_\_\_

N/A

ADD: DATE RECEIVED, ACTION CODE 482, IN REMARKS: 1995, 1996, 1997, 1998

SPECIAL INSTRUCTIONS FOR DATA INPUT: \_\_\_\_\_

COMMENTS \_\_\_\_\_

This instrument was recorded at rec of:

BILL R. VITTITOW  
P.O. BOX 2644  
QUARTZSITE, AZ 85346

COPY



96- 00971

\*OFFICIAL RECORDS OF LA PAZ COUNTY, AZ\*  
\*PATRICIA WALL, LA PAZ COUNTY RECORDER\*  
REC REQ BY: BILL VITTITOW  
14 FEB 1996 02:18 PM PAGE 1 of 2  
RECORDING FEE \$ 10.00

The recording official is directed to return this instrument or a copy to the above person.

Space Reserved For Recording Information

LOCATION NOTICE  
FOR  
MINING CLAIM

MN-1a © LawForms 3-80



Claim (Name and Number, if used) <u>WYNYARRA</u>	LOCATOR OR OWNER (Name, Address and Zip Code) <u>BILL &amp; ARNETTA VITTITOW</u> <u>P.O. BOX 2644</u> <u>QUARTZSITE, AZ. 85346</u>
Type of Claim <input checked="" type="checkbox"/> Placer <input type="checkbox"/> Lode <input type="checkbox"/> Millsite <input type="checkbox"/> Tunnelsite	
Date of Location of Claim <u>FEB 14, 1996</u>	

Type of Notice  
 Amendment to  Original Notice  Relocation Notice  
 If an Amendment or Relocation, Claim was named \_\_\_\_\_ in the prior notice  
 recorded at Docket \_\_\_\_\_, Page \_\_\_\_\_, Mining District, \_\_\_\_\_ County, Arizona.

General Course of Claim is from the NE to the SW  
 Layout of Claim  
 Claim is 1320' feet long and 660' feet wide.  
 Distance from location monument to each end of the Claim is 330 feet in a SW direction and  
1320 feet in a NE direction.

Locality of Notice of Claim and Monument with reference to some natural object or permanent monument  
IN SUNSHINE GULCH - (N. GOODMAN ROAD)  
ABOUT 1 MILE IN A WESTERLY DIRECTION FROM GOODMAN MINE

Effective Date of Notice  
FEB 14, 1996  
 Signature of Locator  
Bill R. Vittitow

INSTRUCTIONS Within 90 days of location of claim:  
 1. Complete above portion of form and post on location monument, and  
 2. Complete two additional copies of entire form, including map on backside, record one with County Recorder and file other with proper BLM office.

Types of Monuments  
 Location Monument is made of STONE, and  
 Corner and End Monuments are made of: STONE

Description of Claim  
 To observe the perimeter of the Claim begin at the ~~SW~~ NE corner and travel  
 in a SW direction 1320 feet to the SW corner monument, thence  
 in a SE direction 660 feet to the SE corner monument, thence  
 in a NE direction 1320 feet to the NE corner monument, thence  
 in a NW direction 660 feet to the NW corner monument, thence

Location of Claim  
 The Claim lies in the NW\* NE quarter of section 27\* - 26 TM  
 Township 4N, Range 21W, G & SR B&M  
 Mining District or Cadastral Subdivision, LA PAZ County, Arizona.  
 The NW corner of the claim lies 330 feet in a WESTERLY direction  
 from the public or established survey monument or permanent natural object described as:

STONE MONUMENT

RECEIVED  
 BLM  
 ARIZONA STATE OFFICE  
 FEB 15 1 22 PM '96

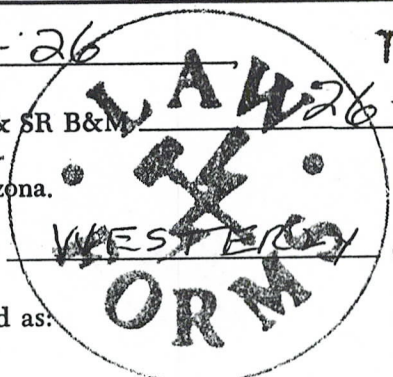

197866 CH A

MAP, PLAT, OR SKETCH  
OF MINING CLAIM

MN-1b © LawForms 3-80



Claim Monument lies in Section 26 & 27 Range 21 W Township 4 N G & SR B & M

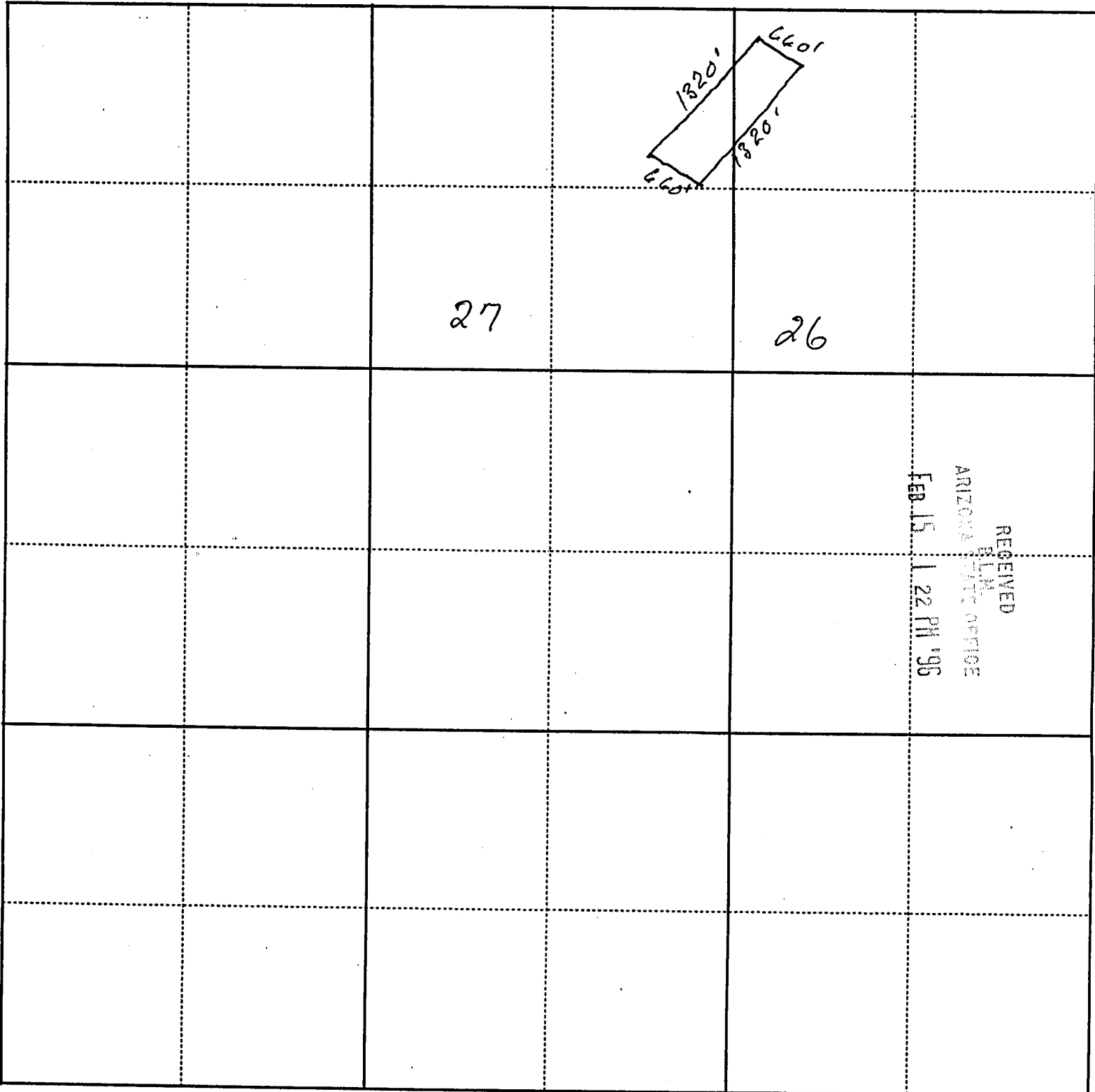

SCALE (Choose One)

1 : 24000 (1 inch = 2000 feet)

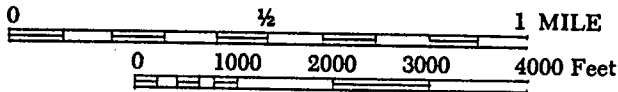

1 : 12000 (1 inch = 1000 feet)

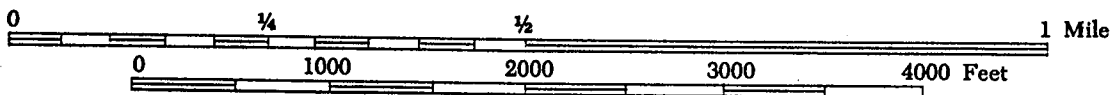

Other (1 inch = not more than 2000 feet)

NORTH ARROW  
(Show Direction)

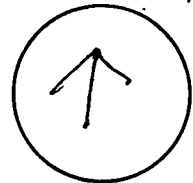

Grid  Magnetic

7 MC 338267

UNITED STATES  
DEPARTMENT OF THE INTERIOR  
BUREAU OF LAND MANAGEMENT  
(Return Address)



POSTAGE AND FEES PAID  
U.S. DEPARTMENT OF THE INTERIOR  
INT-415

State \_\_\_\_\_ Office \_\_\_\_\_

AN EQUAL OPPORTUNITY EMPLOYER

OFFICIAL BUSINESS  
PENALTY FOR PRIVATE USE, \$300

BUREAU OF LAND MANAGEMENT  
DENVER FEDERAL CENTER  
BUILDING 50, SC-610  
P.O. BOX 25047  
DENVER, COLORADO 80225-0047

FINANCIAL DOCUMENTS  
ONLY

- SC-615 = GENERAL ACCOUNTING BRANCH
- SC-616A = DATA CONTROL SECTION
- SC-616B = PAYMENTS SECTION

**SC-616A DATA CONTROL SECTION**

Deposit Tickets (SF-215) including Supporting Documents,  
e.g., Form 1370-35, 1370-40, etc.  
Progress Reports (Form 1681-6)  
Payroll Change Forms (FB-315)  
Automated Payroll Correction Letters (FB305PP1)  
Automated Refunds (Form 1374-1)  
Adjustments to Lease (Form 1370-11 & Form 1371-18)  
Refund Data Sheet (Form 1374-1) including  
DFS (Form 1310-5) or CDS (Form 1370-35)  
Exception in Indirect Cost Rate — Contributed Fund Project  
(Form 1681-3A)

**SC-615 GENERAL ACCOUNTING BRANCH**

Collection Transmittals (Form 1370-8 only) - Enclosed   
Debit Vouchers (SF-5515)  
Fund Transfers Between Agencies (SF-1081 Collection Refunds)  
SIBAC Supporting Documents (Form 1371-23)  
Fuel & Oil Issue Record (Form 1520-28)  
Motor Vehicle Petroleum Issue Record -  
Reimbursable (GSA Form 1374-A)  
Emergency Firefighter Payrolls  
Journal Vouchers (Form 1310-17 & Form 1370-39)  
Unidentified Project Cost Reports (FR-130)  
Stores Control Register (Form 1520-6) including  
Document Face Sheet (Form 1310-5)  
Receiving Report for Stores (DI-102)  
Report of Survey for Stores (DI-103)  
Transfer of Property for Stores (DI-104)  
Inventory of Property for Stores (DI-106)  
Reimbursable Work Project Authorization (Form 1681-3)

**SC-616B PAYMENTS SECTION**

Travel Advance Requests (SF-1038) - Enclosed   
Travel Vouchers (SF-1012) - Enclosed   
Travel Authorizations (DI-1020) - Enclosed   
Reimbursement Vouchers (SF-1129 Imprest) - Enclosed   
Final Salary Clearance (Form 1340-2) - Enclosed

**All Payment Invoices**

Document Face Sheets for Obligations & Payments (1310-5)  
Purchase Orders (Pink & Blue) (OF-347)  
Purchase Orders (SF-44)  
Advertising Orders (SF-1143)  
District Contract Obligations  
District Certificate for Contract Payments (1510-10)  
Receiving Reports (OF-347)  
T.R. Buff copies (SF-1169) including  
Documents Face Sheet (1310-5)  
GSA FEDSTRIP Obligation Copies (SF-3146)  
GSA Self Service Obligations (GSA-831)  
Tort Claims (SF-1145)  
Seed Test Results  
Equipment Order Use Summary & Invoice (1510-18)  
Fund Transfers Between Agencies (SF-1081 - Payments)

KC

GEOGRAPHIC STATE: ARIZONA MERIDIAN: 14 TOWNSHIP: 4-DN RANGE: 21-DW

SEC	SUBDIVISION	MIR	X-REFERENCE	NUMBER/TYPE/DISPOSITION/ACRES	PROPRIETOR/INTEREST/RELATIONSHIP
19	NE	14	3-DN 22-DW	CASE: AZA 000391 TYPE: 362113 FREE USE-ALL-GOVT DISP: CLOSED 04/30/72 ACRS: 00272.500	BR REGIONAL OFFICE 100.00000% PERMITTEE
34	SESE				
35	SWSW				
19	SENE, NESE, N2SWNE			CASE: AZA 004581 TYPE: 361113 NEGOTIATES SALES-AL DISP: AUTHORIZED 12/17/87 ACRS: 00025.000	MASSEY SAND & ROCK 100.00000% PERMITTEE
19	LOT 1			CASE: AZA 006675 TYPE: 387200 PROTESTS & CONTESTS DISP: CLOSED 08/25/89 ACRS: 00002.500	PADEN RAY A 100.00000% HOLDING AGENC
31	S2SE	14	3-DN 21-DW	CASE: AZA 008829	SOUTHWESTERN TEL CO 100.00000% HOLDER/SHILTEE
32	S2S2	14	3-DN 22-DW	TYPE: 286202 ROW-TELEPHONE-TELEG	
33	S2S2	14	4-DN 14-DW	DISP: PENDING 07/31/92	
34	S2SW	14	4-DN 16-DW	ACRS: 00045.140	
35	S2SE	14	4-DN 17-DW		
35	SESE	14	4-DN 18-DW		
36	SENW, N2SW	14	4-DN 19-DW		
36	NWSWSW	14	4-DN 20-DW		
		14	5-DN 14-DW		
		14	5-DN 15-DW		
35	SE	14	3-DN 21-DW	CASE: AZA 00982901	SOUTHWESTERN TEL CO 100.00000% PERMITTEE
36	SENW, SW	14	3-DN 22-DW	TYPE: 280004 ROW TEMP USE PERMIT	
		14	4-DN 19-DW	DISP: CLOSED 07/01/93	
		14	4-DN 20-DW	ACRS: 00052.280	
35	SWSW			CASE: AZA 009850 TYPE: 362113 FREE USE-ALL-GOVT DISP: CLOSED 01/31/82 ACRS: 00001.000	BR REGIONAL OFFICE 100.00000% PERMITTEE
19	N2NE, W2NE, S2NE			CASE: AZA 010015 TYPE: 362113 FREE USE-ALL-GOVT DISP: CLOSED 12/31/82 ACRS: 00001.000	BR REGIONAL OFFICE 100.00000% PERMITTEE
21	SESE			CASE: AZA 010016	BR REGIONAL OFFICE 100.00000% PERMITTEE
22	SWSW			TYPE: 362113 FREE USE-ALL-GOVT	
34	SESE			DISP: CLOSED 02/09/83 ACRS: 00001.000	



-----  
 GEOGRAPHIC STATE: ARIZONA                      MERIDIAN: 14    TOWNSHIP: 4-0N    RANGE: 21-0W  
 -----

SEC	SUBDIVISION	NIR X-REFERENCE	NUMBER/TYPE/DISPOSITION/ACRES	PROPRIETOR/INTEREST/RELATIONSHIP
34	SESE		CASE: AZA 017409	BR REGIONAL OFFICE 100.00000% PERMITTEE
35	SWSW		TYPE: 362113 FREE USE-ALL-GOVT DISP: AUTHORIZED 03/10/82 ACRES: 00080.000	
19	N2NE, W2NE, S2SENE		CASE: AZA 018430	BR YUMA AREA OFFICE 100.00000% PERMITTEE
			TYPE: 362113 FREE USE-ALL-GOVT DISP: AUTHORIZED 02/02/83 ACRES: 00120.000	
21	SESE		CASE: AZA 018431	BR YUMA AREA OFFICE 100.00000% LESSEE
22	SWSW		TYPE: 362113 FREE USE-ALL-GOVT DISP: AUTHORIZED 02/02/83 ACRES: 00080.000	
19	ALL		CASE: AZA 018975	KUNKEL FRANCES 100.00000% LESSEE
20	ALL		TYPE: 311111 O&G LSE NONCOMP PUB	
21	ALL		DISP: CLOSED 08/08/91	
28	ALL		ACRES: 05721.800	
29	ALL			
30	ALL			
31	ALL			
32	ALL			
33	ALL			
19	E2, E2W2		CASE: AZA 020038	CELSIUS ENERGY CO 100.00000% LESSEE
19	LOT 1-4		TYPE: 311211 O&G LSE SIMO PUBLIC	
20	ALL		DISP: CLOSED 03/01/87	
21	ALL		ACRES: 05721.800	
28	ALL			
29	ALL			
30	E2, E2W2			
30	LOT 1-4			
31	E2, E2W2			
31	LOT 1-4			
32	ALL			
33	ALL			
19	N2NE		CASE: AZA 021813	CONTL TEL CO OF CA 100.00000% HOLDER/BILLEE
			TYPE: 286203 ROW-TEL & TELEG, FL	
			DISP: AUTHORIZED 12/10/91	
			ACRES: 00000.412	
19	N2N2NW		CASE: AZA 02181301	CONTL TEL CO OF CA 100.00000% PARTY-IN-INTE
			TYPE: 286209 UNAUTH ACT-ROW-TEL&	
			DISP: CLOSED 12/18/91	
			ACRES: 00000.445	

GEOGRAPHIC STATE: ARIZONA                      MERIDIAN: 14      TOWNSHIP: 4-DN      RANGE: 21-DW

SEC	SUBDIVISION	MIR X-REFERENCE		NUMBER/TYPER/DISPOSITION/ACRES	PROPRIETOR/INTEREST/RELATIONSHIP
36	NE, S2	14	1-DN 8-DW	CASE: AZA 02/1968	ALL AMER PIPELINE CO 100.00000% HOLDER/BILLEE
		14	1-DN 9-DW	TYPE: 288100 ROW-O&G PIPELINES	
		14	1-DN 10-DW	DISP: AUTHORIZED 05/18/85	
		14	1-DS 6-DW	ACRS: 00300.000	
		14	1-DS 7-DW		
		14	1-DS 8-DW		
		14	2-DN 10-DW		
		14	2-DN 11-DW		
		14	2-DN 12-DW		
		14	2-DN 13-DW		
		14	2-DN 19-DW		
		14	2-DS 2-DW		
		14	2-DS 3-DW		
		14	2-DS 4-DW		
		14	2-DS 5-DW		
		14	2-DS 6-DW		
		14	3-DN 13-DW		
		14	3-DN 14-DW		
		14	3-DN 15-DW		
		14	3-DN 16-DW		
		14	3-DN 21-DW		
		14	3-DN 22-DW		
		14	3-DS 1-DW		
		14	3-DS 2-DW		
		14	4-DN 16-DW		
		14	4-DN 17-DW		
		14	4-DN 18-DW		
		14	4-DN 19-DW		
		14	4-DN 20-DW		
		14	4-DS 1-DE		
		14	4-DS 1-DW		
		14	5-DS 1-DE		
		14	5-DS 2-DE		
		14	5-DS 3-DE		
		14	6-DS 2-DE		
		14	6-DS 3-DE		
		14	6-DS 4-DE		
		14	6-DS 5-DE		
		14	6-DS 6-DE		
		14	6-DS 7-DE		
		14	6-DS 8-DE		
		14	6-DS 9-DE		
		14	6-DS 10-DE		
		14	7-DS 10-DE		
		14	7-DS 11-DE		
		14	7-DS 12-DE		
		14	8-DS 12-DE		
		14	8-DS 13-DE		
		14	8-DS 14-DE		

GEOGRAPHIC STATE: ARIZONA                      MERIDIAN: 14      TOWNSHIP: 4-DN      RANGE: 21-DW

SEC	SUBDIVISION	NIR	X-REFERENCE	NUMBER/TYPE/DISPOSITION/ACRES	PROPRIETOR/INTEREST/RELATIONSHIP
		14	9-0S	14-0E	
		14	9-0S	15-0E	
		14	12-0S	19-0E	
		14	13-0S	23-0E	
		14	13-0S	27-0E	
		14	13-0S	28-0E	
		14	13-0S	29-0E	
		14	13-0S	30-0E	
		14	13-0S	31-0E	
		14	13-0S	32-0E	
36	SW	14	1-DN	4-DW	CASE: AZA 022287      SPRINT COMMUNICATION      0.00000% BILLEE
		14	2-DN	5-DW	TYPE: 286203 ROW TEL & TELEG, FL US SPRINT COMM CO      100.00000% HOLDER
		14	2-DN	7-DW	DISP: AUTHORIZED 01/17/90
		14	2-DN	8-DW	ACRS: 00101.970
		14	3-DN	13-DW	
		14	3-DN	14-DW	
		14	3-DN	15-DW	
		14	3-DN	21-DW	
		14	3-DN	22-DW	
		14	4-DN	15-DW	
		14	4-DN	16-DW	
		14	4-DN	17-DW	
		14	4-DN	18-DW	
		14	4-DN	19-DW	
		14	4-DN	20-DW	
		14	13-0S	28-0E	
		14	13-0S	29-0E	
		14	13-0S	30-0E	
		14	13-0S	31-0E	
		14	14-0S	31-0E	
		14	14-0S	32-0E	
		14	16-0S	22-0E	
		14	17-0S	20-0E	
33	SESE PART	14	3-DN	21-DW	CASE: AZA 022867      AZ SHWY      100.00000% PERMITTEE
34	SESE				TYPE: 362113 FREE USE-ALL-GOVT
35	SWSW				DISP: AUTHORIZED 12/22/87
					ACRS: 00095.000
25	PORTION				CASE: AZA 023039      BULLDOG RESOURCES      100.00000% OPERATOR
26	POR OF NE				TYPE: 380913 SURFACE MGT-NOTICE      PATCH DAN      0.00000% CLAIMANT
					DISP: AUTHORIZED 11/27/87
					ACRS: 00001.000
34	SESE				CASE: AZA 023051      HODGE CONSTR CO      100.00000% PERMITTEE
35	SWSW				TYPE: 361113 NEGOTIATED SALES-AL
					DISP: CLOSED 05/25/95
					ACRS: 00000.000

GEOGRAPHIC STATE: ARIZONA                      MERIDIAN: 14    TOWNSHIP: 4-DN    RANGE: 21-DW

SEC	SUBDIVISION	NIR X-REFERENCE			NUMBER/TYPE/DISPOSITION/ACRES	PROPRIETOR/INTEREST/RELATIONSHIP
36	N&B	14	1-DN	8-DW	CASE: AZA 023095	PACIFIC TX PIPELINE 100.00000% HOLDER
		14	1-DN	9-DW	TYPE: 288100 ROW-0% PIPELINES	
		14	1-DN	10-DW	DISP: AUTHORIZED 05/23/86	
		14	1-DS	6-DW	ACRS: 00300.000	
		14	1-DS	7-DW		
		14	1-DS	8-DW		
		14	2-DN	10-DW		
		14	2-DN	11-DW		
		14	2-DN	12-DW		
		14	2-DN	13-DW		
		14	2-DS	2-DW		
		14	2-DS	3-DW		
		14	2-DS	4-DW		
		14	2-DS	5-DW		
		14	2-DS	6-DW		
		14	3-DN	13-DW		
		14	3-DN	14-DW		
		14	3-DN	15-DW		
		14	3-DN	16-DW		
		14	3-DN	21-DW		
		14	3-DN	22-DW		
		14	3-DS	1-DW		
		14	3-DS	2-DW		
		14	4-DN	16-DW		
		14	4-DN	17-DW		
		14	4-DN	18-DW		
		14	4-DN	19-DW		
		14	4-DN	20-DW		
		14	4-DS	1-DE		
		14	4-DS	1-DW		
		14	5-DS	1-DE		
		14	5-DS	2-DE		
		14	5-DS	3-DE		
		14	6-DS	2-DE		
		14	6-DS	3-DE		
		14	6-DS	4-DE		
		14	6-DS	5-DE		
		14	6-DS	6-DE		
		14	6-DS	7-DE		
		14	6-DS	8-DE		
		14	6-DS	9-DE		
		14	6-DS	10-DE		
		14	7-DS	10-DE		
		14	7-DS	11-DE		
		14	7-DS	12-DE		
		14	8-DS	12-DE		
		14	8-DS	13-DE		
		14	8-DS	14-DE		
		14	9-DS	14-DE		

GEOGRAPHIC STATE: ARIZONA MERIDIAN: 14 TOWNSHIP: 4-0N RANGE: 21-0W

SEC	SUBDIVISION	NTR	X-REFERENCE	NUMBER/TYPE/DISPOSITION/ACRES	PROPRIETOR/INTEREST/RELATIONSHIP
		14	9-0S 15-0E		
		14	12-0S 19-0E		
		14	13-0S 23-0E		
		14	13-0S 27-0E		
		14	13-0S 28-0E		
		14	13-0S 29-0E		
		14	13-0S 30-0E		
		14	13-0S 31-0E		
		14	13-0S 32-0E		
19	LOT 1			CASE: AZA 023276 TYPE: 292803 UNAUTHORIZED OCCUPA DISP: PENDING 04/21/88 ACRS: 00001.000	PADEN RAY A 100.00000% PARTY-IN-INTE
23	SE	14	4-0N 20-0W	CASE: AZA 023284 TYPE: 380913 SURFACE MGT-NOTICE DISP: CLOSED 07/28/93 ACRS: 00002.000	BLM YUNA DO 0.00000% OFFICE OF REC BREAKWATER RESOURCES 100.00000% OPERATOR HELNICK PAUL 0.00000% CLAIMANT PATCH DAN 0.00000% CLAIMANT
24	SW				
25	NE				
21	PORTION OF ALL	14	3-0N 21-0W	CASE: AZA 023285 TYPE: 380913 SURFACE MGT-NOTICE DISP: AUTHORIZED 04/27/88 ACRS: 00005.000	FULLER JAY 0.00000% CLAIMANT VICKERY JOHN 100.00000% OPERATOR
22	PORTION OF N2				
27	PORTION OF ALL				
34	PORTION OF ALL				
35	PORTION OF S2				
34	SESE			CASE: AZA 023286 TYPE: 362113 FREE USE-ALL-BOVT DISP: CLOSED 11/11/88 ACRS: 00095.000	LA PAZ CO PUB WORKS 100.00000% APPLICANT
35	SWSW				
20	NWSWNW			CASE: AZA 023298 TYPE: 361113 NEGOTIATES SALES-AL DISP: AUTHORIZED 03/09/89 ACRS: 00010.000	NASSEY SAND & ROCK 100.00000% PERMITTEE
22	NE			CASE: AZA 023362 TYPE: 380913 SURFACE MGT-NOTICE DISP: AUTHORIZED 01/18/89 ACRS: 00005.000	FULLER JAY 100.00000% OPERATOR FULLER JAY 0.00000% CLAIMANT
34	SESE			CASE: AZA 023381 TYPE: 361113 NEGOTIATES SALES-AL DISP: EXPIRED 03/13/92 ACRS: 00040.000	TED'S TRUCK CENTER 100.00000% PERMITTEE
35	SWSW				

*N/A*

GEOGRAPHIC STATE: ARIZONA MERIDIAN: 14 TOWNSHIP: 4-0N RANGE: 21-0W

SEC	SUBDIVISION	NTR X-REFERENCE	NUMBER/TYPE/DISPOSITION/ACRES	PROPRIETOR/INTEREST/RELATIONSHIP
26	NW		CASE: AZA 024224 TYPE: 380913 SURFACE MGT-NOTICE DISP: AUTHORIZED 04/18/95 ACRS: 00005.000	BLM YUMA DO 0.00000% OFFICE OF REC FLETCHER CHARLES 100.00000% OPERATOR FLETCHER CHARLES 0.00000% CLAIMANT
34	SESE		CASE: AZA 024799 TYPE: 362113 FREE USE-ALL-GOVT DISP: AUTHORIZED 10/19/90 ACRS: 00001.000	PALO VERDE IRRIGATIO 100.00000% PERMITTEE
35	SWSW			
25	POR		CASE: AZA 024817 TYPE: 380913 SURFACE MGT-NOTICE DISP: AUTHORIZED 08/23/84 ACRS: 00001.000	W&F PROPERTIES INC 100.00000% OPERATOR
35	POR			
25	S2	14 4-0N 20-0W	CASE: AZA 024822 TYPE: 380913 SURFACE MGT-NOTICE DISP: AUTHORIZED 12/12/91 ACRS: 00004.000	BLM YUMA DO 0.00000% OFFICE OF REC MONTGOMERY BRANDY 100.00000% OPERATOR PATCH DAN 0.00000% CLAIMANT
26	S2			
35	POR			
34	SESE		CASE: AZA 024876 TYPE: 361113 NEGOTIATED SALES-AL DISP: PENDING 10/18/90 ACRS: 00080.000	CRAWFORD ASSOCIATES 100.00000% APPLICANT
35	SWSW			
020	NESWNW, NWSENW, S2SENW		CASE: AZA 025253 TYPE: 361313 MIN MAT SALE-COMP-A DISP: AUTHORIZED 06/16/92 ACRS: 00040.000	GRANITE CONSTR CO 100.00000% PERMITTEE
21	W2		CASE: AZA 026509 TYPE: 361113 NEGOTIATED SALES-AL DISP: PENDING 03/09/92 ACRS: 00040.000	BLM YUMA DO 0.00000% OFFICE OF REC EDSTROM CONSTRUCTION 100.00000% APPLICANT
22	E2			
23	SE		CASE: AZA 026538 TYPE: 380913 SURFACE MGT-NOTICE DISP: CLOSED 09/24/94 ACRS: 00005.000	BLM YUMA DO 0.00000% OFFICE OF REC ORO GRANDE MINING CO 100.00000% OPERATOR
19	NE, N2NW		CASE: AZA 026908 TYPE: 287001 ROW-WATER FACILITY DISP: AUTHORIZED 08/10/95 ACRS: 00001.653	GRANITE CONSTR CO 100.00000% APPLICANT

GEOGRAPHIC STATE: ARIZONA      MERIDIAN: 14      TOWNSHIP: 4-0N      RANGE: 21-0W

SEC	SUBDIVISION	NTR X-REFERENCE	NUMBER/TYPE/DISPOSITION/ACRES	PROPRIETOR/INTEREST/RELATIONSHIP
19	N2NENE, W2NE, S2SENE		CASE: AZA 027046 TYPE: 362113 FREE USE-ALL-GOVT DISP: PENDING 07/27/93 ACRS: 00120.000	BR YUMA AREA OFFICE 100.00000% APPLICANT
21	SESE		CASE: AZA 027047 TYPE: 362113 FREE USE-ALL-GOVT DISP: PENDING 07/27/93 ACRS: 00060.000	BR YUMA AREA OFFICE 100.00000% APPLICANT
22	SWSW			
23	SE	N/A	CASE: AZA 027060 TYPE: 380913 SURFACE MGT-NOTICE DISP: AUTHORIZED 11/30/83 ACRS: 00000.500	ANOCO MINERALS CO 100.00000% OPERATOR BLM YUMA DO 0.00000% OFFICE OF REC PATCH DAN 0.00000% CLAIMANT
25	NW			
26	NE			
21	SESE		CASE: AZA 027268 TYPE: 361113 NEGOTIATED SALES-AL DISP: PENDING 10/01/92 ACRS: 00001.000	BLM YUMA DO 0.00000% OFFICE OF REC GRANITE CONSTR CO 100.00000% APPLICANT
22	SWSW			
34	SESE		CASE: AZA 027763 TYPE: 361113 NEGOTIATED SALES-AL DISP: CLOSED 07/28/93 ACRS: 00001.000	BLM YUMA DO 0.00000% OFFICE OF REC RAMSEY HOLLIS 100.00000% PERMITTEE
35	SWSW			
34	NESE		CASE: AZA 028076 TYPE: 380913 SURFACE MGT-NOTICE DISP: AUTHORIZED 08/31/93 ACRS: 00004.900	BLM YUMA DO 0.00000% OFFICE OF REC BROCK TED 50.00000% OPERATOR BROCK GAE 50.00000% OPERATOR
35	S2S2			
33	SE		CASE: AZA 028079 TYPE: 380913 SURFACE MGT-NOTICE DISP: AUTHORIZED 08/31/93 ACRS: 00004.900	BLM YUMA DO 0.00000% OFFICE OF REC SCHMIDT WELLER 100.00000% OPERATOR SCHMIDT WELLER 0.00000% CLAIMANT
21	SE		CASE: AZA 028100 TYPE: 380913 SURFACE MGT-NOTICE DISP: AUTHORIZED 08/31/93 ACRS: 00004.900	BLM YUMA DO 0.00000% OFFICE OF REC RONEY RONALD E 100.00000% OPERATOR RONEY RONALD E 0.00000% CLAIMANT
34	SESE		CASE: AZA 028205 TYPE: 361113 NEGOTIATES SALES-AL DISP: PENDING 12/13/92 ACRS: 00001.000	BLM YUMA DO 0.00000% OFFICE OF REC
35	SWSW			

GEOGRAPHIC STATE: ARIZONA MERIDIAN: 14 TOWNSHIP: 4-0N RANGE: 21-0W

SEC	SUBDIVISION	M/R X-REFERENCE	NUMBER/TYPE/DISPOSITION/ACRES	PROPRIETOR/INTEREST/RELATIONSHIP
36	W2		CASE: AZA 028275 TYPE: 380913 SURFACE MGT-NOTICE DISP: AUTHORIZED 12/02/93 ACRS: 00001.000	BLM YUMA DO 0.00000% OFFICE OF REC KING MIN TESTING LAB 100.00000% OPERATOR SCHLIEKELMAN JOHN D 0.00000% CLAIMANT
36	NW		CASE: AZA 028438 TYPE: 292803 UNAUTHORIZED OCCUPA DISP: PENDING 02/04/90 ACRS: 00001.000	BLM YUMA DO 0.00000% OFFICE OF REC SCHLIEKELMAN JOHN D 50.00000% PARTY-IN-INTE
23	SE		CASE: AZA 028439 TYPE: 292803 UNAUTHORIZED OCCUPA DISP: PENDING 06/09/90 ACRS: 00001.000	BLM YUMA DO 0.00000% OFFICE OF REC UNKNOWN 100.00000% PARTY-IN-INTE
24	NW	N/A	CASE: AZA 028440 TYPE: 292803 UNAUTHORIZED OCCUPA DISP: PENDING 04/09/90 ACRS: 00001.000	BLM YUMA DO 0.00000% OFFICE OF REC BRANDT FRED 100.00000% PARTY-IN-INTE
23	SESW		CASE: AZA 028441 TYPE: 292803 UNAUTHORIZED OCCUPA DISP: PENDING 06/09/90 ACRS: 00001.000	BLM YUMA DO 0.00000% OFFICE OF REC UNKNOWN 100.00000% PARTY-IN-INTE
26	NW	N/A	CASE: AZA 028442 TYPE: 292803 UNAUTHORIZED OCCUPA DISP: PENDING 04/09/90 ACRS: 00001.000	BLM YUMA DO 0.00000% OFFICE OF REC UNKNOWN 100.00000% PARTY-IN-INTE
26	SWNW	N/A	CASE: AZA 028443 TYPE: 292803 UNAUTHORIZED OCCUPA DISP: PENDING 04/09/90 ACRS: 00001.000	BLM YUMA DO 0.00000% OFFICE OF REC UNKNOWN 100.00000% PARTY-IN-INTE
22	SENE		CASE: AZA 028519 TYPE: 292803 UNAUTHORIZED OCCUPA DISP: PENDING 12/16/93 ACRS: 00001.000	BLM YUMA DO 0.00000% OFFICE OF REC UNKNOWN 100.00000% PARTY-IN-INTE
23	NESENW		CASE: AZA 028520 TYPE: 292803 UNAUTHORIZED OCCUPA DISP: PENDING 12/16/93 ACRS: 00001.000	BLM YUMA DO 0.00000% OFFICE OF REC UNKNOWN 100.00000% PARTY-IN-INTE



GEOGRAPHIC STATE: ARIZONA MERIDIAN: 14 TOWNSHIP: 4-0N RANGE: 21-0W

SEC	SUBDIVISION	MIR X-REFERENCE	NUMBER/TYPE/DISPOSITION/ACRES	PROPRIETOR/INTEREST/RELATIONSHIP
28 33	NE, NW, SW, SE N2		CASE: AZA 028978 TYPE: 380913 SURFACE MGT-NOTICE DISP: AUTHORIZED 05/06/94 ACRS: 00003.000	BLM YUMA DO 0.00000% OFFICE OF REC CARTER LAUREN W 50.00000% OPERATOR CARTER LAUREN W 0.00000% CLAIMANT CLINE STEPHEN 50.00000% OPERATOR CLINE STEPHEN 0.00000% CLAIMANT
26	NE	N/A	CASE: AZA 028953 TYPE: 380913 SURFACE MGT-NOTICE DISP: CLOSED 08/18/94 ACRS: 00020.660	BLM YUMA DO 0.00000% OFFICE OF REC
26	SE	N/A	CASE: AZA 029075 TYPE: 380913 SURFACE MGT-NOTICE DISP: CLOSED 07/28/95 ACRS: 00004.990	BLM YUMA DO 0.00000% OFFICE OF REC HOWELL MICHAEL G 100.00000% OPERATOR HOWELL MICHAEL G 0.00000% CLAIMANT
25 36	S2 W2NE, NW, SW		CASE: AZA 029124 TYPE: 380913 SURFACE MGT-NOTICE DISP: CLOSED 08/15/95 ACRS: 00004.990	BLM YUMA DO 0.00000% OFFICE OF REC BROCK MARVIN A 0.00000% CLAIMANT BROCK LOUISE 0.00000% CLAIMANT HOWELL MICHAEL G 100.00000% OPERATOR
23	SE		CASE: AZA 029154 TYPE: 380913 SURFACE MGT-NOTICE DISP: AUTHORIZED 06/17/95 ACRS: 00004.250	AZ GOLD MINE INC 0.00000% CLAIMANT BLM YUMA DO 0.00000% OFFICE OF REC MONTGOMERY B 100.00000% OPERATOR
36	NW		CASE: AZA 029155 TYPE: 380913 SURFACE MGT-NOTICE DISP: AUTHORIZED 06/15/95 ACRS: 00004.990	MONTGOMERY BEN 100.00000% OPERATOR MONTGOMERY BEN 0.00000% CLAIMANT
36	SW	14 2-0N 16-0W 14 2-0N 17-0W 14 2-0N 18-0W 14 3-0N 18-0W 14 3-0N 19-0W 14 3-0N 20-0W 14 3-0N 21-0W 14 3-0N 22-0W 14 4-0N 20-0W	CASE: AZAR 0003819 TYPE: 288100 ROW-O&G PIPELINES DISP: AUTHORIZED 10/17/52 ACRS: 00250.670	EL PASO NATURAL GAS 100.00000% HOLDER
35 36	SESESE SWSW, NWSESW, SWNESW	14 3-0N 21-0W 14 4-0N 20-0W	CASE: AZAR 0027681 TYPE: 282105 FED AID HIGHWAY (SE) DISP: AUTHORIZED 10/07/60 ACRS: 00001.000	AZ SHWY 100.00000% HOLDER

GEOGRAPHIC STATE: ARIZONA      MERIDIAN: 14      TOWNSHIP: 4-0N      RANGE: 21-0W

SEC	SUBDIVISION	MIR	X-REFERENCE	NUMBER/TYPE/DISPOSITION/ACRES	PROPRIETOR/INTEREST/RELATIONSHIP
3	S2S2			CASE: AZAR 0071213 TYPE: 362113 FREE USE-ALL-GOVT DISP: CLOSED 04/03/67 ACRS: 00001.000	BR REGIONAL OFFICE 100.00000% PERMITTEE
35	S2SE			CASE: AZAR 0033227 TYPE: 362113 FREE USE-ALL-GOVT DISP: CLOSED 01/30/74 ACRS: 00001.000	BR REGIONAL OFFICE 100.00000% PERMITTEE
36	SW,SEW	14	3-0N 21-0W 14 3-0N 22-0W	CASE: AZPHX 0079556 TYPE: 281001 ROW-ROADS DISP: AUTHORIZED 04/17/43 ACRS: 00006.820	LA PAZ CNTY BD SUPV 100.00000% HOLDER
36	NESW,S2SW,NENW	14	2-0N 10-0W 14 2-0N 11-0W 14 2-0N 12-0W 14 2-0N 13-0W 14 2-0N 14-0W 14 2-0N 15-0W 14 2-0N 17-0W 14 2-0N 18-0W 14 3-0N 18-0W 14 3-0N 19-0W 14 3-0N 20-0W 14 3-0N 21-0W 14 3-0N 22-0W 14 4-0N 20-0W	CASE: AZPHX 0083225 TYPE: 288100 ROW-O&G PIPELINES DISP: AUTHORIZED 11/04/64 ACRS: 00456.220	EL PASO NATURAL GAS 100.00000% HOLDER/BILLEE
36	SW	14	3-0N 11-0W 14 3-0N 21-0W 14 3-0N 22-0W 14 4-0N 12-0W 14 4-0N 14-0W 14 4-0N 16-0W 14 4-0N 17-0W 14 4-0N 18-0W 14 4-0N 19-0W 14 4-0N 20-0W 14 5-0N 12-0W 14 5-0N 13-0W 14 5-0N 14-0W	CASE: AZPHX 0083392 TYPE: 286203 ROW-TEL & TELEG, FL DISP: AUTHORIZED 03/12/85 ACRS: 00193.570	AT&T CONTRACT MGT 100.00000% HOLDER/BILLEE
35	S2SE	14	3-0N 21-0W	CASE: AZPHX 0083767 TYPE: 282105 FED AID HIGHWAY (SE) DISP: AUTHORIZED 07/29/47 ACRS: 00052.800	AZ SHWY 100.00000% HOLDER

GEOGRAPHIC STATE: ARIZONA                      MERIDIAN: 14      TOWNSHIP: 4-0N      RANGE: 21-0W

SEC	SUBDIVISION	NIR X-REFERENCE		NUMBER/TYPER/DISPOSITION/ACRES	PROPRIETOR/INTEREST/RELATIONSHIP
36	W2			CASE: AZPHX 0083776 TYPE: 282105 FED AID HIGHWAY (SE DISP: AUTHORIZED 07/03/47 ACRS: 00032.140	AZ SHWY                      100.00000% HOLDER
*19	M&B	14	5-0N 21-0W	CASE: AZPHX 0086679	CONTL TEL CO OF CA      100.00000% HOLDER
*20	M&B	14	6-0N 21-0W	TYPE: 286202 ROW-TELEPHONE-TELEG	
*30	M&B	14	7-0N 20-0W	DISP: AUTHORIZED 11/08/07	
*31	M&B	14	7-0N 21-0W	ACRS: 00001.000	
		14	8-0N 19-0W		
		14	8-0N 20-0W		
		14	8-0N 21-0W		
		14	9-0N 19-0W		
		14	9-0N 20-0W		
		14	10-0N 19-0W		

\* = REJECTED/SEGREGATED/ASSIGNED-OUT

CASE TYPE: ALL      DISPO: ALL

14      4-0N      21-0W

